

NEW PRODUCT PREVIEW

A SAMPLE OF NEW PRODUCTS SET
TO DEBUT AT FABTECH 2021



 **FABTECH**

NORTH AMERICA'S LARGEST METAL FORMING,
FABRICATING, WELDING AND FINISHING EVENT

MAKE IT **HERE**

SEPTEMBER 13-16

McCormick Place / Chicago, IL

2021

THANK YOU TO OUR
PLATINUM SPONSORS



REGISTER TODAY fabtechexpo.com

EVENT PARTNERS



An Evolution In Bending.



HRB ATC High-Precision Press Brake Series

With Automatic
Tool Changer (ATC)

Manufactured in
High Point, NC

- Average tool setup 1-2 minutes.
- One HRB ATC replaces 2-3 standalone press brakes.
- 3-fold job increase and the ideal solution for high-mix, low-volume.
- Utilizes economical, American-made HRB AFH tooling.
- Total bending solution reduces the need for skilled operators.

72% Setup Time Reduction With ATC

Time Breakdown For Each Process – Average over an 8-hour shift

Industry Average	5.1%	Job Scheduling	1.4%	AMADA HRB ATC
	14.8%	Planning & Programming	1.2%	
Total Setup Time	21.7%	Tool Setup	3.7%	
	5.9%	Machine Adjustment	1.2%	
59.2%	11.7%	Test Bending	9%	
	17.4%	Inspection & Production Control	9.3%	
	8.1%	Machine Idle	8.1%	17.4%

76.6%

Total Idle Time

33.9%

23.4%

Green-Light-On Time

66.1%

Scan each
QR code for video.

From Production
To Rush Job in Minutes



Made in USA Expedites Delivery



Customers previously achieving 10-12 setups per shift now complete 35-45 setups per shift utilizing the HRB ATC.



AMADA AMERICA, INC.

180 Amada Court • Schaumburg, IL 60173

www.amada.com/america

877-262-3287

To arrange for a virtual demonstration of this machine or any of AMADA's innovative solutions, please contact your local Sales Engineer. Conveniently view demos at your facility, or any remote location, on your choice of computer or mobile device.



MAKE IT HERE

See, touch and discover the latest technology and innovation you need to transform your business at FABTECH 2021. Explore aisle after aisle of new product launches and equipment demonstrations. Network with peers, learn from the pros and gain insights that will change the game for your career and business.

Register to attend TODAY at fabtechexpo.com

LEARN Gain valuable, can't-miss insights from best-in-class conference programs that target technical, lean, operational, and managerial segments.

CONNECT Visionary keynotes and expert panels allow attendees to network with peers, exchange best practices, and learn about the latest industry advancements.

COMPARE Discover advanced technologies that improve quality and productivity and compare innovative solutions from world-class exhibitors side-by-side.



HEALTH & SAFETY FIRST

FABTECH leads the way in bringing the industry together in 2021. Our top priority remains the health and safety of all those on-site at the event.

Learn more about what you can expect at the show at fabtechexpo.com/safetyfirst.

TABLE OF CONTENTS

General Show Information	3
Hotel & Travel	4
Exhibitor List	6-9
New Products	10-37
Arc Welding	10
Automation	10-11
Bending/Forming	11-13
Business Services	13
Coil Processing	13
Cutting	13-14
Fastening & Joining	14
Finishing	14-20
Gases & Gas Equipment	20
Inspection & Testing	20-21
Job Shop/Contract Manufacturing	21
Lasers	21-22
Machining/EDM	22
Maintenance & Repair	22
Material Handling/Marking	22-23
Other Machinery/Equipment/ Parts/Products	23-26
Plate & Structural Fabricating	27
Press Brakes	27-28
Punching	28
Resistance Welding	28
Robotics	28-30
Safety & Environmental	30-31
Saws & Cut-off Machines	31
Software & Machine Controls	32
Stamping	32-33
Tool & Die	33
Tooling	33
Tube & Pipe Fabricating or Welding	33-35
Tube & Pipe Producing	35
Waterjet	35-36
Welding Consumables	36
Welding Machines/Equipment	36-37
Special Events	38-41
Conference Program	
Schedule-At-A-Glance	42-45
Conference Pricing	46

MCCORMICK PLACE

2301 S. Martin Luther King Dr.
Chicago, IL 60616

LAKESIDE CENTER (East Building)

METALFORM
Finishing
Tube/Pipe

SOUTH BUILDING

Forming & Fabricating
3D/Additive Mfg

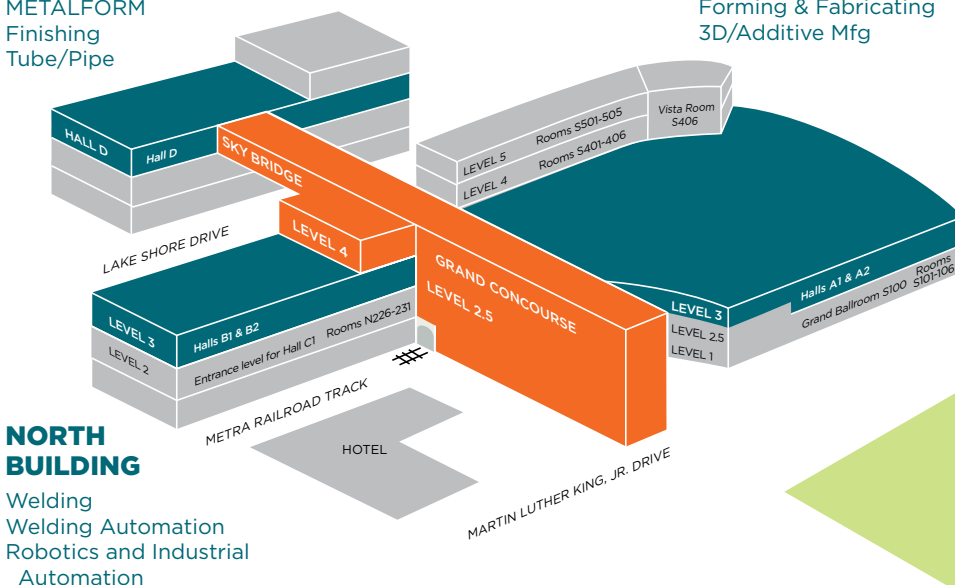

NORTH BUILDING

Welding
Welding Automation
Robotics and Industrial
Automation

New Product Preview | Volume 9 | September 2021

The New Product Preview is published annually on behalf of FABTECH® by The Fabricators and Manufacturers Association International® 2135 Point Blvd | Elgin, IL 60123 USA | 815-399-8700 | fabtechexpo.com | fmanet.org

START PLANNING TODAY!

DESTINATION CHICAGO

Chicago has something for everyone. From world-class museums, parks and amazing architecture to shopping on the Magnificent Mile, a wide range of dining options, and much more!

SHOW ADMISSION

Exhibit-only attendance is FREE if you register by September 9, 2021. Beginning September 10, the cost to attend the exhibits is \$50. AWS, FMA, SME, PMA and CCAI members may always attend the exhibits for FREE with a valid member card.

Register today at fabtechexpo.com.

SHOW HOURS

Monday, Sept. 13 10 AM* – 6 PM
Tuesday, Sept. 14 9 AM – 5 PM
Wednesday, Sept. 15 9 AM – 5 PM
Thursday, Sept. 16 9 AM – 3 PM

**EAST BUILDING (LAKESIDE CENTER) OPENS AT 9 AM*

GET THE BEST HOTEL SELECTION AND SAVINGS

Book your stay through onPeak, FABTECH's Official Hotel Provider, for guaranteed lowest rates and big benefits — including complimentary shuttle service and no booking or service fees!

Reserve your rooms early for the best selection and price — hotels sell out quickly.

Visit fabtechexpo.com/accommodations.



Download the FABTECH app to access show info on the go — exhibits, a floor plan, sessions, agenda planner and more at fabtechexpo.com/mobile-app.



Mobile App Sponsored By:



The TRUMPF logo consists of the word "TRUMPF" in a bold, black, sans-serif font, positioned above a solid blue square. The entire logo is enclosed within a white rectangular border.

TRUMPF



Combination Processing Reimagined The new TruMatic 3000 fiber

With a revolutionary design that increases quality and productivity, TRUMPF has reimagined combination processing with the new TruMatic 3000 fiber. Unmatched punching and forming capabilities are achieved with the delta drive punching head, which features all-tool rotation, programmable stroke depth and standard descending die for scratch-free processing. Laser cutting on the TruMatic 3000 fiber is consistent and reliable thanks to the renowned TruDisk laser and collision-protected cutting unit. To maximize productivity, the TruMatic 3000 fiber offers automatic loading and a variety of unloading and sorting capabilities, as well as future integration to storage systems. Stop by FABTECH booth A2904 to see how TRUMPF's commitment to advancing technology can benefit you.

See TRUMPF at FABTECH Booth A2904 / www.trumpf.com

EXHIBITOR LIST (as of June 26, 2021)

3D/ADDITIVE MANUFACTURING

Air Products and Chemicals Inc
Creaform
Digilant.net
EnvisionTEC Inc
Essentium
Faspro Technologies Inc
Formlabs
Fusion3 3D Printers
GIE Media Inc
Manufacturing Automation Systems
Markforged
Product Innovation and Engineering LLC
TIGER-VAC USA INC
Verisurf Software Inc

FINISHING

Accudraft Paint Booths
Acme Finishing
ADF Systems Ltd
AEREM Industrie Inc
AFC Finishing Systems / Airblast AFC
Air and Liquid Systems Inc
AIS Finishing Systems
AkzoNobel Powder Coatings
Alconox
Alliance Manufacturing Inc
AM Industrial Group
American Grinders Inc
Amiberica Inc
Arnold Machine Inc Automation / FMT Parts Washers
Arrow Cryogenics Inc
Atotech USA LLC
Axalta Coating Systems
AZZ Metal Coatings
B.L. Downey Company LLC
BEKO Technologies
Belco Industries Inc
BiRAS Boya Pazarlama
Blast Cleaning Technologies
BlastOne
BPE Group
CALDAN Conveyor
CAPLUGS / SHERCON
Carbit Paint Co
Cardinal Paint and Powder
Carlisle Fluid Technologies
Castrol / BP Lubricants
Catalytic Industrial Systems
Chemical Coaters Assoc International
ChemQuest Inc
Circle-Proscio Inc

FINISHING

ClearClad Coatings LLC
Combustion and Systems Inc
Cool Clean Technologies LLC
CPR Systems
Daifuku America Corporation
Decoral System USA Corp
DeFelsko Corp
Diamond H2O
Diamond Vogel Paint & Coatings
Dinamec Systems
DuBois Chemicals Inc
Durable Blast Parts LLC
Dürr Systems, Inc.
ECO Burn-Off Ovens
Elcometer Inc
EPSI Engineered Products and Services Inc
Ervin Industries
ESMA Incorporated
FANUC America Corp
Fischer Technology Inc
Frohn North America
GAT Finishing Systems
Gema USA Inc
General Fabrications Corp
George Koch Sons LLC
Global Finishing Solutions
Goff Inc
Graco Inc
HafcoVac
Hedson Technologies North America
Henkel Corp
Hentzen Coatings Inc
Heraeus
HERR Industrial Inc
Honeywell Safety Products
Horizon Performance Technologies LLC
IFS Coatings Inc
IntelliFinishing
IPCM International Paint & Coating Magazine
IST International Surface Technologies
Keyland Polymer UV Powder LLC
Klinger Paint Co
Kyzen Corporation
LDPI Inc
LestaUSA
LINE-X Industrial Coatings
LPI Lift Systems
LS Industries Inc
M L Filters

FINISHING

MacDermid Envio Solutions (formerly known as DMP Corporation)
Master Finish Company
Mid America Powder Coating
Midco International Inc
Midwest Finishing Systems
Mighty Hook Inc
Nordson Corp
Nutro Inc
Omnirobotic
Pangborn LLC
Parker Engineering of America
Patriot Metal Finishing
Patriot Powder Coating
PEM Inc
Plateco Inc
Pneu-Mech Systems Mfg
Pollution Control Products Co
Powder Coated Tough
Powder Coating Institute
Powder-X Coating Systems
PPG
Production Plus Corp
Products Finishing Magazine
Quaker Houghton
RGI Spraybooths.Net
Richards-Wilcox Inc
Riveer
RollSeal Inc
Ruwac Industrial Vacuums
Sames Kremlin
Sata Spray Equipment
Scientific Industrial Nano Engineering - SINE
Seymour of Sycamore Inc
Sherwin-Williams
Sistem Teknik Makina San Ve Tic AS (Electron)
Southern Systems International LLC
Spray Enclosure Technologies
Spray Systems Inc
Sprimag Inc
System Technologies
TCI Powder Coatings
The Electrocoat Association
Therma-Tron-X Inc
Thermion
Titan Catalytic
Transmet Corp
Trimac Industrial Systems
Tristar Coatings Ltd
Tsunami Compressed Air Solutions
United Surface Solutions LLC

FINISHING

Valmont Coatings
VaporTech
Venjakob North America Inc.
Vulkan Blast Shot Technology
W Abrasives
Wagner Industrial Inc
Washington Mills Ceramics
Webb-Stiles Co
Wheelabrator Group

FORMING & FABRICATING

1960 SERAVESI
3Arm America
3D Fab Light Inc
Accurpress
AccuStream Inc
Accutek Waterjet
Acrotech Inc
Addison Machine Engineering Inc
Aeromet Industries Inc
Ajan Elektronik Servis Sanayi Ve Ticaret Ltd St
AKS Cutting Systems Inc
Akyapak USA
Allor Manufacturing Inc/Plesh Industries
Allstrap Steel & Poly Strapping Systems
Alma CAM USA LLC
Alpha Laser US
Alro Steel, Industrial & Plastics
Alternative Parts Inc
AM Machinery Sales Inc
Amada America Inc
American Machinery Group Llc
American Photonics
American Punch Co
AMS Controls Inc
ANDRITZ Metals USA Inc
Apex Machine Group
Aptean Inc
ARK Chemicals Ltd
ARKU Inc
Armstrong Kover Kwick Inc
Arro-Mark Co LLC
Arrowhead Manufacturers & Fabricators Assoc
ASC Machine Tools
Ascentium Capital
Automated Fabrication Systems
Automated Gasket Corp
Automated Layout Technology
Automec Inc

FORMING & FABRICATING

AWS Schäfer Technologie GmbH
AZ Industrial Lasers
Azak Tool Technologies Inc
Barefoot Ergonomic Flooring by Beagle I Inc
BARTON International
Baykal Makina
Behringer Saws Inc
Bendmak Machinery
BesCutter Inc
Big Ass Fans
Big Steel Rack
Bissell Commercial
Blastec Inc
BLM Group
boeck GmbH
Bosch Rexroth Corp
Boschert Precision Machinery Inc
Boss Laser
Bradbury Group
Braner USA Inc
Bruker Alicona
BTM Company LLC
Bud's MT
Bunting-Newton
Burr King Manufacturing Co
Business Engineering America Inc
Business Network For Offshore Wind
Butech Bliss
BUWW Coverings Inc
Bystronic Inc
Cain & Company
Cameron Manufacturing & Design
Camlock Systems Inc
Carell Corporation
CH Steel Solutions Inc
Chambrelan SAS
Chase Cooling Systems
Chicago Metal Fabricators
CIDAN Machinery Inc
Cincinnati Inc
Cle-Line by Greenfield Industries
Cleveland Punch & Die Co
Cleveland Steel Tool Co
Closed Loop Recycling
CMS North America Inc
COLE-TUVE Inc
COMEQ Inc
Conperio Technology Solutions
Controlled Automation Inc

FORMING & FABRICATING

Cosen Saws, North America
 Costa Sanders Custom Rollforming Corp / Marion Die and Fixture
 Daito Seiki Co Ltd
 Dake Corporation
 Dallan America Corp
 Dalmecc Inc
 Danobat
 Darex LLC
 data M Sheet Metal Solutions GmbH
 DAVI Inc
 DELMIAworks
 Dener USA
 Diamond Saw Works Inc
 Dimeco
 DoALL Sawing Products
 Doringer Cold Saws
 Doucet Machineries Inc
 Dr. Shrink Inc
 Dreistern Inc
 Dude Solutions
 DURMA North America
 Dynatect Manufacturing Inc
 Eagle Bending Machines Inc
 Eagle Laser
 Eastern Metal Supply
 Ebbco Inc
 EBS Ink-Jet Systems USA Inc
 ECI Software Solutions
 Edison Lighting Supply LLC
 Ehrt North America
 Element
 ELG Metals Inc
 Elumatec North America Inc
 EMH, Inc.
 Emmegi USA Inc
 Enfasco Inc
 Epicor ERP Software
 Epilog Laser Corp
 Ercolina - CML USA Inc
 Ergotronix
 ERIEZ
 ERMAKSAN / ERMAKUSA
 ExhibitForce
 Fab Supply Inc
 Fabricating & Metalworking Magazine

FORMING & FABRICATING

Fabrication Solutions & Technologies Inc
 Fabricators & Manufacturers Assoc Intl (FMA)
 FabStation by Eterio Realities
 FACCIN USA, INC
 FactoryCat Industrial Equipment
 Fagor Automation Corp
 Family Business USA
 FARO Technologies Inc
 Fehr Warehouse Solutions Inc
 FF Journal/Modern Metals
 FICEP Corporation
 FINISHLINE
 Fladder
 FlashCut CNC
 Flex Machine Tools
 Flow Waterjet
 FomUSA
 Formdrill USA Inc
 Formtek Inc
 Fromm Packaging Systems
 Fulcrum
 Gasparini SpA
 GE Mathis Co
 Geka USA
 Generon
 Geneva Capital LLC
 Genius ERP
 Gentec Electro-Optics Inc
 GIZA Steel
 Global Shop Solutions
 GMA Garnet (USA) Corp
 Gorbelt Inc
 Grotnes Inc
 GT SCHMIDT
 Haberle / Ken Bergman & Associates
 Haeger Inc. A Pennengineering Company
 HAEUSLER AG Duggingen
 Hafendorfer Machine Inc
 Hangzhou Xiangsheng Abrasive Machine Manufacturing Co. Ltd (Jonsen Sander)
 Han's Laser Smart Equipment Group
 Hans Weber Sales and Service Corp
 Hanstahl Machinery

FORMING & FABRICATING

Heck Industries
 HEM Inc
 Hexagon
 HK Laser & Systems
 Holtec Gas Systems
 HYDMECH
 Hydradyne LLC
 Hypertherm Inc
 II-VI Infrared
 Industrial Machinery Digest
 Industrial Magnetics Inc
 InfoSight Corporation
 Inspeccion
 International Knife & Saw Inc
 International Technologies Inc
 Into-N2 LLC
 iSS
 J&S Machine Inc
 Jacquet Midwest Inc
 Jepson Power Inc
 Jet Edge
 JHP Fasteners Inc
 JIE USA Inc
 Jinan Bodor CNC Machine Co Ltd
 JMR Industrial
 Jobscope ERP
 Johnson Bros Roll Forming Co
 KAAST Machine Tools Inc
 Kalamazoo Machine Tool
 KD Capital Equipment LLC
 Keep The Heat
 Keller USA Inc
 Kern Laser Systems
 Kinetic Cutting Systems Inc
 Kinkelder USA
 Kipp Inc
 Kjellberg Cutting, Inc.
 KMT Waterjet
 KOHLER Maschinenbau GmbH
 KOLEV Engineering Inc
 Laguna Tools Inc
 Lantek Sheet Metal Solutions
 LAP LASER
 Lapham-Hickey Steel
 LaserStar Technologies Corporation
 Laservision USA
 Lazer Safe Pty Ltd
 LeClaire Manufacturing

FORMING & FABRICATING

LENOX®
 LINSINGER
 LISSMAC Corp
 Lyon Metals LLC
 MachineTools.com
 Machitech Automation
 Manufacturing News
 Marketing Essentials LLC
 Masteel America Corp
 Master Roll Manufacturing
 Mate Precision Technologies
 Mazak Optonics Corp
 MD Metals
 Messer Cutting Systems
 Metal Center News
 Metal Supermarkets
 MetalFinish LLC
 MetalForming Inc
 Metalix CAD/CAM Ltd
 Metform International Ltd
 Mid Atlantic Machinery Automation
 Midwest Automation
 Midwest Tool Inc
 MIE Solutions Inc
 Mikropor Makina Sanayi Ve Ticaret AS
 Ming Ping Machinery Co Ltd
 Mitsubishi Laser, Press Brake, & Automation - MC Machinery Systems, Inc.
 Modula Inc
 MSS Nitrogen Inc
 MultiCam Inc
 Muratec
 Nano Purification Solutions
 Nitto Kohki USA Inc
 nLIGHT Inc
 Nordfab Ducting
 Norlok Technology Inc
 Ocean Machinery Inc
 Ohio Laser LLC
 OMAX Corp
 OMCO Rollforming Plus
 OmegaCube Technologies
 Oncor
 Ophir
 Orion Machinery North America
 OZEN Compressed Air Technology

FORMING & FABRICATING

Pacific Press Technologies
 Packsize International LLC
 Pannier Corporation
 Paper-Less LLC
 Paperless Parts
 Park Industries
 Parmigiani Macchine
 Pat Mooney Inc
 Peddinghaus Corporation
 PEP Technology
 Perfection Global LLC
 Permador Industries Inc
 Philpott/Lankhorst
 Phoenix Metals Co
 Pivatic
 Polyurethane Products Corp
 Power Solutions Pro
 Premium Plate
 Press Brake Repair
 Press Brake Safety
 Presto Ecoa Lifts
 Prima Power North America Inc
 Prodevco Robotics Solutions Inc
 Produtech
 Project Tool & Die Inc
 ProScale
 Protected Flow Manufacturing
 Qnect LLC
 QPS Evaluation Services Inc./QPS America Inc.
 Quantum Machinery Group
 R&M Manufacturing Co LLC
 Radan
 Ragnar Makine San Tic Ltd STI
 Raincatcher
 RAS Systems LLC
 Ratner Steel
 Ray Tools Inc
 RDI Laser Blanking Systems
 Red Bud Industries
 Red Wing Software Inc
 Remgrit Carbide Grit Cutting Tools
 Replacement Brush Tables
 Revolution Machine Tools
 Richardson Electronics Ltd

FORMING & FABRICATING

Rigaku Analytical Devices
 Rigid-Tex
 Rocklin Manufacturing Co
 Rolled Metal Products
 Roller Die + Forming Co
 Roller USA
 RUF Briquetting Systems
 S.M.A.R.T. Services
 Safan Darley B.V.
 Salvagnini America Inc
 Samco Machinery Ltd
 Samson Roll Formed Products Co
 SB Whistler & Sons Inc
 Schelling America Inc
 Scotchman Industries Inc
 SDS2
 SENFENG
 Service Lamp Corp
 Shop Floor Automations Inc
 ShopBot Tools Inc
 ShopData Systems Inc
 SigmaTEK Systems LLC
 Simonds Saw LLC
 SizTech LLC
 SKM Industries Inc
 Slatpro LLC
 SLTL Group (Sahajanand Laser Technology Ltd)
 SME ZONE
 South Tek Systems
 Spanco Inc
 Spraying Systems Co
 Stainless Structurals LLC
 STAM SpA
 Stanza Machinery
 Staub Manufacturing Solutions
 Steel King Industries Inc
 Steel Mountain Marketing
 Steel Storage Systems Inc
 SteelStack
 Stor-Loc Corp
 Striker Systems
 STRUMIS LLC
 Super Duty Fans
 Tanis Brush
 Tapeswitch Corporation
 T-Drill Industries Inc
 Team Texas
 Techni Waterjet A GMM Group Company
 Ted Machines Inc
 TEKFAB Inc

FORMING & FABRICATING

Texas Right Corner
 The Fabricator Magazine
 The M.K. Morse Company
 Thermo Fisher Scientific
 Three D Metals Inc
 Timesavers LLC
 Tocho Marking Systems America
 Toolmen Corp
 Trilogly Machinery Inc
 Trimble Solutions USA Inc
 Trim-Lok Inc
 Tru-Cut Saw Inc
 TRUMPF North America
 Tsune America LLC
 TTEngineering
 TYKMA Electrox
 Ultra Consultants
 Unist Inc
 Ursviken Inc
 US Industrial Machinery Co
 V&S Galvanizing
 Versatility Tool Works & Mfg Company Inc
 Viking Blast and Wash Systems
 Virtek Vision
 VKS
 voestalpine Roll Forming Corp
 VX-LLC
 Vytex Laser Systems
 Waldemar Design & Machine LLC
 WARDJet - AXYZ
 Weil Technology North America
 Wells Lamont Industrial
 Welser Profile
 Wila USA
 Wilson Tool International
 Wysong
 Xometry
 YESTOOL / Aloris USA
 Zund America

METALFORM

Accra-Wire Controls Inc
 Accurate Die Design Software Inc./Logopress
 Agathon Machine Tools Inc
 AIDA-America
 Alma Machinery Co
 Almco Inc
 Amada Press System America
 AP&T North America Inc
 ART Metals Group
 AutoForm Engineering USA Inc
 Automated Tapping Systems
 BCN Technical Services Inc
 Beckwood Press Co
 Berg & Co GmbH Spanntechnik
 Biele S A
 Bihler of America
 Bruderer Machinery
 BTD Tooling Division
 Chemcoaters LLC
 Clayton Metals
 COACT
 COE Press Equipment Corporation
 Colt Automation LTD
 Dallas Industries Inc
 Daubert Cromwell
 DDI Inc
 Delta Computer Systems Inc
 Delta Industrial
 DENN - Industrias Puigjaner, sa - Global Metal Spinning Solutions
 Dexco Structural Racking Systems
 Diehl Steel Co Inc
 DieTronic
 Digital Tool & Die Inc
 DREHER Automation
 DTC Products Inc
 Dubuque Laser & Fabrication
 Eagle Metals
 Eagle Press & Equipment Co Ltd
 EAS Mold & Die Change Systems Inc
 Era Wire Inc
 F&G Tool and Die Co
 Fibro Inc
 FluidForming Americas

METALFORM

FORMTEK-ME
 Fortech Products Inc
 Green Valley Manufacturing Inc
 Greenerd Press & Machine Company Inc
 Gruber Tool & Die Inc
 HMS Products Co
 Hursan Pres
 Hutchison Tool
 IHI Ionbond Inc
 Impax Tooling Solutions
 Industrial Innovations Inc
 Jarvis Cutting Tools
 JET-SET
 JIER North America
 JK Prototype Inc
 J-Tech Design
 K&K Tool and Die Inc
 Kaeser Compressors Inc
 Komatsu America Industries LLC
 Kyntronics
 Lee Industrial Contracting
 Leifeld Metal Spinning GmbH
 Lenzkes Clamping Tools Inc
 Linear Transfer Automation Inc
 Link Systems
 Logopress/Accurate Die Design Software Inc
 LSP Industries Inc
 Machine Concepts Inc
 Macrodyne Technologies Inc
 Mayfran International Inc
 Metalloid Corporation
 Midwest Industrial Metals Corp
 Mission Tool & Machine LLC
 MJC Engineering & Technology Inc
 Monode Marking Products
 MPI Magnetic Products Inc
 Multipress Inc
 Oberg Industries Inc
 Orttech Inc
 Overton Industries Tool & Die
 P/A Industries Inc
 Pascal Engineering Inc
 Pax Products Inc
 Penn United Technologies Inc
 Pottiez America LP

METALFORM

Precision Brand Products Inc
 Precision Metalforming Association
 Precision Punch Corp
 Precision Stamping Products
 Press Room Equipment Co
 Pronic Inc
 PUNCH INDUSTRY USA INC
 Raffin Construction Co
 Rapid-Air Corporation
 Ready Technology Inc
 Rock Valley Oil & Chemical Co Inc
 Roemheld
 Roll Out Racks
 Rollomatic Inc
 Schuler Inc
 SelfLube
 SEYI America Inc
 ShopEdge Software Inc
 SIMPAC America Co Ltd
 Solar Atmospheres
 Special Springs LLC
 Stamtec Inc
 Steel Craft Technologies
 STEINEL Normalien AG
 Superior Die Set Corp
 Taylor Made Solutions Inc
 Toledo Integrated Systems / Toledo Transducers
 Torque Technologies/ Goizper
 Tower Metalworking Fluids
 Towsleys
 TOX Pressotechnik LLC
 Trans-Matic
 T-Sim Solutions
 TST Tooling Software Technology LLC
 Tsubaki - Kabelschlepp
 Ulbrich Stainless Steels & Special Metals Inc
 Ultralox
 Unico Inc
 UNISORB
 Unist Inc
 United Aluminum Corp
 United Wire Co Inc
 Universal Feed & Machine
 Vibro Dynamics LLC
 Victory Tool
 Voith US Inc
 Vulcan Tool Company

METALFORM

Weldcraft Products Co
 Wintriss Controls Group LLC
 Zapp Precision Strip
 Zerust Corrosion Solutions
ROBOTICS & INDUSTRIAL AUTOMATION
 Abka Yazilim Otomasyon Ltd Sti
 Accu Tech USA
 ACCUFACTURE LLC
 Air and Hydraulic Equipment Inc
 Apex Dynamics
 Applied Robotics Inc
 Arixo Company
 Beckhoff Automation
 Bishop-Wisecarver
 CADDIS Systems
 Center for Naval Metalworking (CNM)
 Festo Corp
 GAM Enterprises
 GearKo
 Harmonic Drive LLC
 igus Inc
 IKO International Inc
 KEBA Corp
 Kosmek USA
 Lasermet Inc
 Mach Machines LLC
 Metamation Inc
 Nabtesco
 NB Corporation of America
 New Forge LLC
 New London Engineering
 Newall Electronics Inc
 NUM AG
 Path Robotics Inc
 Pepperl+Fuchs Inc
 Sage
 Schaefer Systems International Inc
 SMC Corporation of America
 TESEO SRL
 TR Electronic
 TRUMPF Laser Technology
 TURCK Inc
 Two Technologies Inc
 Vidir Solutions
 Waypoint Robotics Inc

TUBE & PIPE

5 Star Engineering
 Accurex Measurement Inc
 Advanced Tubular Technologies Inc
 Alpine Bender Machinery
 ASMAG USA Inc
 Bend-Tech LLC
 Chiyoda Kogyo-Maruka USA
 Clark Fixture Technologies
 Comco USA Inc
 Continental Pipe & Tube Cut-Off Machines
 Copier Inc
 Crippa USA
 Design Storage & Handling Inc
 FD Machinery
 Fives
 Galaxie Corporation
 GFU- Maschinenbau Tube End Forming Machines
 Guild International
 Hammond Roto-Finish
 Horn Machine Tools Inc
 Huth Ben Pearson International LLC
 IP Automation
 ITEC - Innovative Tube Equipment Corporation
 J&S Machine Inc
 Julia USA
 Kent Corporation
 Magnetic Analysis Corp
 Mair Research SpA
 Manchester Tool & Die Inc
 Metalloid Corporation
 Mill Masters
 NDT Technologies Inc
 Numalliance North America / AddEaton
 OMCG Inc
 OMNI-X USA
 OP USA Inc
 Overton Industries Tube Forming Systems
 Paperboard Packaging Solutions
 Passline Performance
 PHI Hydraulics
 PRD Company / Cagil Makina
 Rafter Equipment Corp
 Roll Machining Technologies & Solutions
 Rust Release (Safe Industrial Rust Remover)
 Saar Hartmetall USA LLC

TUBE & PIPE

Schwarze-Robitec GmbH
T&H Lemont
Tekmak Global
Thermatool Corp
Tools for Bending
Transfluid Tube Processing Machinery Inc
Tru-Cut Saw Inc
Tube & Pipe Technology Magazine
Tube 2022
Tube-Line Technologies
Uniflex Of America
Universal Tool & Engineering
Universal Tube & Rollform Equipment Company
US Lubricants
Various Machining Solutions LLP
VLB North America
VOLLMER of America
WAFIOS Machinery Corp
Wauseon Machine & Manufacturing Inc
World Machinery & Saw Inc

WELDING

Absolent Inc
Ace Industrial Products
ACT Dust Collectors
AGT Robotics
Air Purification Inc
Airflow Systems Inc
AirMax
Allied Powers LLC
ALM Positioners Inc
Ambrell Induction Heating Solutions
American Technical Publishers
American Torch Tip Co Inc
American Welding Society
Anthony Welded Products Inc
Anxin Abrasives
Arc Solutions Inc
ArcBoss
Arkansas Elite Welding Academy
ASSA ABLOY Entrance Systems
ATA Tools Inc
ATI Industrial Automation
Auburn Manufacturing Inc
AVS Industries LLC
AWS Bookstore
Bend-Tech LLC

WELDING

Black Stallion (Revco)
Bluco Corp
Blue Demon Welding Products
Bollhoff USA
Bosch Rexroth Corp
Bradford Derustit Corp
Buffalo Shrink Wrap
Cambridge Vacuum Engineering
Capital Weld Cleaners
Carr Lane Manufacturing Co
Cerbaco Ltd
CGW Abrasives
Champion Cutting Tool
Chart Inc
Chicago Pneumatic Tool Company LLC
CK Worldwide
CO2Meter
Computers Unlimited
CORAL Antipollution Systems
COR-MET INC
Coxreels
CS Unitec Inc
CWB Group
D/F Machine Specialties Inc
Dedeco International Inc
Direct Wire
Dongguan Kingdom Abrasives Co Ltd
DualDraw LLC
Dynabrade Inc
EASYKleen Pty Ltd
eldec LLC
Electron Beam Technologies Inc
Encompass Machines Inc
ESCO Tool Company
Eurovac Inc
FANUC America Corp
FeoClean
Filter-1
Fireball Tool
Fischer Engineering Co
Flame Tech
Flex Arc
Flexovit USA Inc
FLIR Systems
FOCUS
Forney Welding & Metalworking
Genstar Technologies Co Inc (GENTEC)
GH Induction Atmospheres LLC

WELDING

Gullco International Inc
Harbert's Products/Allied Flux
HBS Stud Welding Partners
HGG Profiling Equipment Inc
Hobart Institute of Welding Technology
Hundal Group
IDEAL
II-VI Infrared
IMPACT
InterTest Inc
IVOSTUD GmbH
IWT Stud Welding
JASIC Technologies America Inc
JLC Electromet Pvt Ltd
John Tillman Co
JR Automation
Kalas
KBG Welding
Kennametal Inc
Kistler Welding and Cutting Automation
Levitac Technologies Inc
LightSAFE - LightWELD
Linde plc
Luvata Ohio Inc
Manufacturing Solutions Industries Inc
Mathey, B&B Pipe, PPM, Fit-Up Pro, TAG Pipe
McDantim Inc
MCR Safety
MELTRIC Corporation
Michigan Pneumatic Tool Inc
Micro Air
Midalloy
MTA-USA LLC
Nelson Stud Welding Inc
Norton Abrasives
NUBURU Inc
Oasis Scientific Inc
Olympus America Inc
Optrel Inc
Outlaw Leather
Oxylance Inc
Pador Group - Rotoweld
Pandjiris Inc
Pemamek LLC
Pioneer IWS
Pipe Pro Guides
Plasma Automation
plasmo USA LLC
Portwest LLC

WELDING

Preco Inc
Pro Spot International
Proceq USA Inc
Protective Industrial Products Inc
Pyramex Safety Products
Radyne Corp
Rex-Cut Abrasives
Robotic Technologies of Tennessee LLC
Sanpo Publications Incorporated
SanRex Corporation
Sawblade.Com
sia Abrasives
Sideros Engineering
Southern Stud Weld Inc
SSC Controls Co
Steelmax Tools
Strong Hand Tools
Suhner Industrial Products Inc
Sumig USA Corp
Sumner A Southwire Company
Sunstone Welders
Superflash Compressed Gas Equipment Inc
Surface Engineering Alloy Co
Surface Flow Technologies Inc/LSN Diffusion Ltd
T. J. Snow Company
Techniweld USA
Tenryu
Threaded Fasteners Inc
Thred Taper
TIG Brush
Travelers Alliance Group
Trendex Inc
TRU-WELD
TWI North America
U-Mark Inc
United Abrasives Inc / SAIT
Up In Smoke Welding Apparel Inc
Urrea Professional Tools
Vessel / SP Air
Vicon Machinery LLC
Victory CNC Plasma Systems
ViewTech Borescopes
VSM Abrasives Corp
Walter Surface Technologies
Washington Alloy Co
Watts Mueller

WELDING

Weld Metals Online
Weld Pride USA LLC
WeldComputer
Weldcote Metals
Weldobot
Wendt USA LLC
WITT Gas Controls
Wurth Industry North America
Wurth Van Horn
Yaskawa Motoman Robotics
Zipp Air Tool
WELDING AUTOMATION
3M
ABB Robotics & Discrete Automation
Aimtek Inc
AKH Inc
AMET Inc
ARC Specialties Inc
AXXAIR USA
Balaster LLC
Bear Knuckles
Beveler USA Inc
BUG-O SYSTEMS
CEIA USA Induction Heating Systems
CENIT North America Inc
CM Industries Inc
COB Industries Inc
Coherent Inc
Continental Abrasives
Diablo Tools
Diagraph Marking and Coding An ITW Company
Fusion Inc
Goss Inc
Gretchen International
Gudel Inc
Holemaker Technology LLC
Hypertherm Inc
IPG Photonics
Izumi Friction Welding / All World
Kawasaki Robotics (USA) Inc
Koike Aronson Inc
K-TIG
KUKA Robotics
Laser Marking Technologies/
Laser Manufacturing Technologies LLC
Laser Mechanisms Inc
Laserline Inc

WELDING AUTOMATION

Markal
Melton Machine & Control Co
Metabo Power Tools
MITUSA Inc
MSC Software
OTC DAIHEN Inc
Pearl Abrasive Company
Pleatco Filtration
Precitec Inc
Preston Eastin
Primo Automation Systems
PTR-Precision Technologies Inc
Pulsa
Quantum Machinery Group
Rapol Inc
RIDGID
SciAps Inc
SEC Industrial
SERVO-ROBOT
Sigma DT Robotics
Staubli Corp
Steiner Industries
Taylor-Winfield Technologies
THE ROUECHE CO LLC
The Tack Shield
Translas
UNIBOR
Universal Robots
Uniweld Products Inc
Vanterm Isi Ve Makina San Tic AS
Vectis Automation
Weiler Abrasives
Weldas Co LLC
Weldsale LLC
Welker Engineered Products
Xiris Automation Inc

EXPLORE NEW PRODUCTS AT FABTECH

The following pages in this New Product Preview offer a glimpse of what's in store at FABTECH. Find descriptions and images of new machinery, new materials and new processes listed by technology and company name. To view a complete list of all new products offered, click on the Exhibitor Directory tab at fabtechexpo.com.

Arc Welding

IWT Stud Welding

Booth B37060
LYNX Freedom



Battery powered drawn arc stud welder. Weld range: #10 - 1/2", 900amps, 6 welds per minute. Charging input: 115VAC.

MITUSA Inc

Booth B15043
MITUSALATOR Unitized Manipulator Column and Boom



Unitized welding manipulator column and boom design for pipe shops. Set up in minutes. The boom arm swivels into position for easy welding process control equipment mounting.

OTC DAIHEN Inc

Booth B27021
Welbee II



Welbee II is the next generation of advanced welding technology from OTC DAIHEN. Suitable for manual or robotic welding, Welbee II features a streamlined, digital control panel.

Welbee P400L



Welbee P400L welding power source combines the proven pulsing technology of the P400 welder with the exclusive Low Spatter mode, now available in a 400A, single/three-phase welder capable of reducing weld spatter and MIG welding root passes.

RKX220



RKX220 Professional-Grade AC/DC TIG welding package combines advanced welding technology of OTC DAIHEN and the professionally-curated welding accessories of Instagram's @kanekid, Rush Kane.

TRUMPF North America

Booth A2904
TruArc Weld 1000



Quick programming, reliable welding: the TruArc Weld 1000 has the complete package for getting started with automated arc welding even with low production quantities

Automation

Amada America Inc

Booth A2104
AMS 3015 CLT Automation



Manufactured with precision at our facility in Brea, California, the AMS CLT can automatically and consistently perform material handling operations to maximize machine productivity.

Bystronic Inc

Booth A2126
ByTrans Modular



From a single machine to multiple machines with material warehousing and automated parts sorting, ByTrans Modular offers a variety of scalable solutions to expand material automation capabilities as your production requirements change.

IPG Photonics

Booth B27038
LightWELD 1500 Handheld Laser Welding System



LightWELD handheld laser welding is easy to learn and provides consistent high-quality results across a wide range of materials and thicknesses. Weld thick, thin and reflective metals with low heat input and wobble control for up to 5mm of addtl weld width.

Kyntronics

Booth D47252
SMART Electro-Hydraulic Actuator



The all-in-one Kyntronics SHA combines the power of hydraulics with the precision of servo control. Actuators with up to 170,000 LBs (755 kN) of force that have superior functionality compared with HPUs/cylinders or EMAs.

Lasermet Inc

Booth B12021
Laser Castle Lite - Handheld Laser Welding Cabin



Laser Castle Lite is the self-assembly, laser welding safety cell ideal for hand-held-laser welding operations and for small robots used in laser cutting and laser welding.

Modula Inc

Booth A5761
Modula Lift NG



Modula's VLMs are fully automated vertical storage systems that take up a minimum footprint by taking advantage of high ceilings, thus maximizing storage potential.

Two Technologies Inc

Booth B16008
HMIQ Automation

HMIQ Automation end-to-end solution applications include: automated test processes, data logging/IIoT, existing equipment upgrades into "Smart" Equipment, equipment diagnostics and Training.

Vectis Automation

Booth B17054
Vectis HD Cobot Welding Tool - Water Cooled

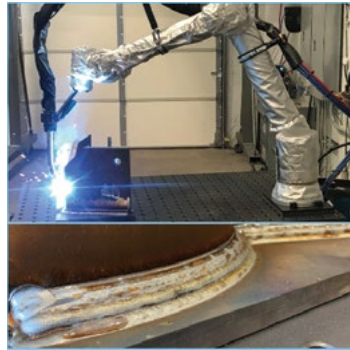

The heavy-duty version of our Cobot Welding Tool comes with a 450 amp welder and a stout water-cooled torch. It's in the field welding 0.045", 0.052", and 1/16" wire all day long.

Vectis ArcPilot: Through-The-Arc Seam Tracking



ArcPilot brings through-the-arc seam tracking to cobot welding. This feature enables fabricators to compensate on-the-fly for production realities such as distortion, inconsistent parts/fixtures, and imperfect programming.

Deployment Options for Vectis Systems



Expanded Cobot Welding Deployment Options



The standard mobile cart enables versatility for many applications but when you need a different way to get the cobot to the joint or a larger workspace deployment options for the Vectis system include the Boom, XL Cart and more.

Welder Options for Vectis Systems



In addition to Miller Invision-based standard systems, we now offer additional welder options from Miller, Lincoln, and Fronius that will enable more applications and fit your shop's existing equipment needs and preferences.

Vectis Cobot Hardfacing Tool

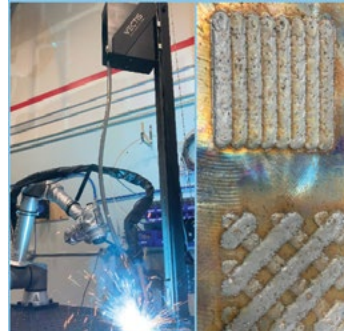

Cobot Hardfacing Tool offers manufacturers, alloy cladders, repair shops, equipment rental centers, and rebuild operations a flexible, easy-to-program, and hardworking tool to offload the dull task of hardfacing/buildup.

Bending/Forming

Berg & Co GmbH Spanntechnik

Booth D47545
Berg Hydraulic Chain Actuated Clamping Systems



Berg Spanntechnik hydraulic chain actuator BKZ/PKV travels automatically in the T-slot of the press slide between the park position and respective die.

Bihler of America

Booth D47124
4Sslide-NC



Next-generation servo technology provides unmatched levels of productivity and operational efficiency with features and benefits that include: integrated process and production monitoring, and faster production speeds.

Carell Corporation

Booth A5314
BA-40 CNC Section Bending Machine

BA40 3 driven rolls. Hydraulic Positioning. CNC controls **NEW!**



Automatic Cycle with direct insertion of the radius and bending data, to obtain many different shapes

Eagle's BA-40 CNC Machine incorporates PROBENDING Servo Controlled Leading Edge Technology providing material feeds from left or right making it a truly accurate and universal job shop or production machine.

Carell Corporation continued on next page. ▶

Bending/Forming

BA-55 CNC Section Bending Machine

BA55 3 driven rolls, Hydraulic Positioning, CNC controls **NEW!**



Automatic Cycle, with direct insertion of the radius & bending data, to obtain most any shape

The BA55's CNC, Double Pinch, 3 driven rolls are managed by an easy-to-use Servo Controlled "PROBENDING" system. Create variable radii shapes and polycentric forms using most any material type or profile. Precision built for high production applications.

Crippa USA

Booth D45932
Tube Bending Endforming Machines and Work Cells



Tube bending, endforming and processing consist of several operations that require increasingly more integration of complex and multi-disciplinary technologies.

data M Sheet Metal Solutions GmbH

Booth A3493
Perfect Roll Forming

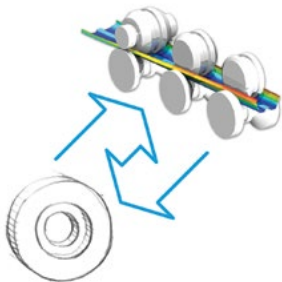

With just a few clicks, COPRA® users can integrate their roll design in the production cycle speeding up the manufacturing process tremendously.

Dreistern Inc

Booth A5104
DREISTERN Roll Forming 4.0



Intelligent Roll Forming shortens "Time to Market".

FACCIN USA, INC

Booth A4912
Plate Roll 4HEP Electric Model



The model features a compact and solid structure thanks to the use of more resistant and innovative steels, that together with new energy efficiency technology, achieve an optimal combination that maximizes productivity while reducing running costs.

Horn Machine Tools Inc

Booth D45940
HMT



All-Electric machines that set up automatically, quickly and are intentionally designed to withstand 24/7 production.

Fusion



The power of Fusion combines the Horn USA All-Electric bender design with the efficiency and experience of CSM's manufacturing capability.

Horn Metric



HORN Metric Series CNC Tube Benders - choose from single stack, dual stack, NC single axis, and NC multi axis, hydraulic drive or hybrid drive tube bending machines.

Safan Darley B.V.

Booth A2158
E-Brake Mini Cell



The Mini Cell is a fully automatic bending cell and brings all the features available in the larger automated cells, all in the smallest foot print of its class. The E-Brake Mini Cell has a modular build up, so you add only the options you need.

Schwarze-Robitec GmbH

Booth D45954
CNC 80 E TB MR

The fully electric CNC 80 E TB MR multi-radius tube bending machine is an absolute allrounder - designed for high volumes, short cycle times and resource-saving material handling.

Trilogy Machinery Inc

Booth A4961
SYNERGY Bending Rolls



Synergy AH4-10/13 10' x 1/2" Mild Steel Pre-Bending to 19" ID

SYNERGY Bending Rolls available in either three-roll or four-roll configuration.

Ursviken Inc

Booth A4531
PivaBend MPB600

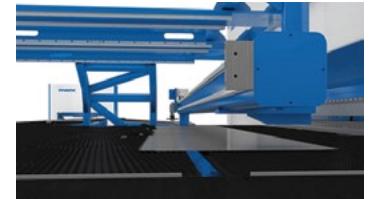

XXL Panel Bender capable of bending 19.6 feet long parts.

VLB North America

Booth D46163
Fully Electric CNC Rotative Head Tube Benders



EB-RH series bending machines, with rotating heads, contain advanced electric motion technology with 11 fully electric drive shafts. Allows the production of very complex parts in automatic bending cycle.

Fully Electric CNC Tube Benders | EB Series



The EB-CNC series electric VLB bending machines are equipped with the latest Electric Motion technology. With up to 9 fully electric drive axis, pipes from 6 to 150 mm can be bent. Booster system, allows radii up to 1D with reduced clamp marks.

Pipe End Forming Machines | EF Series



Fast, accurate and versatile end forming machines that enable the endforming of pipes with high complexity, high deformation levels and high repeatability. Can be equipped with up to 6 forming stations, including rotary stations.

Angle Rolls - Section Benders | SB Series



VLB profile rollers offer endless possibilities for bending profiles and pipes, regardless of the dimensions. VLB range of bending machines is suitable for bending large pipe diameters and profiles up to IPE1000.

Business Services

American Welding Society

Booth B25008

Welding Solutions Online Course

An online course designed to help develop highly knowledgeable and effective sales personnel.

Marketing Essentials LLC

Booth A3555

Virtual Selling Solutions - Sales Coaching



How we sell has changed. It's both face-to-face and virtual. To win, sales teams must have the right approach, tools, and skillset to allow them to transition quickly and flawlessly between both environments.

Coil Processing

Allor Manufacturing Inc/ Plesh Industries

Booth A3560

84" Slitting Line Leveler



84" Slitting Line Leveler. Roll plunge based on gauge and yield, positions machine for desired plastification. Real time roll bending corrects strip defects.

Precision Tapered Backup Bearings



Backup Bearings give direct interchange 2.5"- 11.375". All bearings are sealed or shielded for life, and are heat-treated using bearing-quality steel. Our attention to detail gives you increased performance for all of your backup bearing needs.

Work Rolls



Work Rolls meet the highest standards for material, finish, tolerance, strength and reliability to keep your production moving for your leveling equipment. Work roll sizes available in "Inch" and "Metric" diameters.

Danobat

Booth A3176

X-GAP by Danobat for Coil Fed Fiber Laser Systems

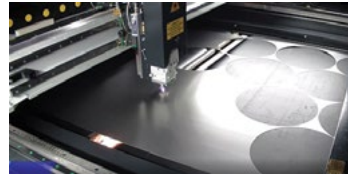

X-GAP by Danobat: adaptive expanding gap system that increases efficiency and opens new possibilities to the production with Danobat LB coil-fed fiber laser blanking systems.

Produtech

Booth A3176

EffiCoil Coil Fed Fiber Laser-Punching System



A coil fed fiber laser-punching machine equipped with two compact and independent working heads, an electric punching unit and fiber optic laser cutting head.

VLB North America

Booth D46163

Electric NC Tube Benders | ECO Series



The bending machines of the ECO-NC series are easy to operate, robustly constructed and achieve excellent bending results.

Roll Forming Lines for Sheet Metal | RF Series

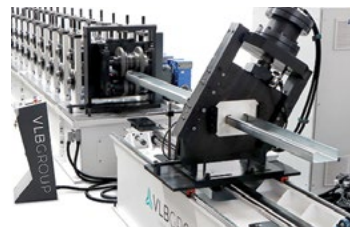

Automatic profiling lines. VLB develops, produces and installs technical support.

Cutting

Biele S A

Booth D46843

Vision & Handling Equipment for Laser Blanking



The Laser Blanking line system detects blanks embedded in the metal band from which they have been cut by laser with the required accuracy and speed.

ESCO Tool Company

Booth B37012

COHOG® Split-Frame Clamshell Machine

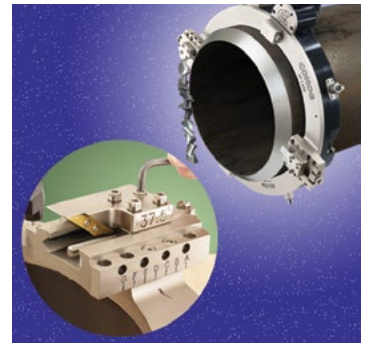

COHOG® Clamshell Split-Frame machine for parting and beveling pipe features a new module cutting blade system with double-edged insert bits is available for sale or rent and manufactured in the USA ESCO Tool.

Haberle / Ken Bergman & Associates

Booth A3254

Compound Cutting Saw



Tilting saw head allows vertical mitering 0°-90° to the right side. The vise in place, it allows compound angles with tilted head 0°- 45° and mitered vise 0°- 60° according to the 1°- graduations.

Cutting

Julia USA

Booth D46477
EVOLUTION



Evolution assures higher performances than standard HSS blades, in M2 or M35 steel, in every cutting condition.

LENOX®

Booth A3543
GEN-TECH



Set-Style Carbide Tipped Band Saw Blade for general purpose cutting. Low cost per cut with versatile, set-style tooth design for use on wide range of materials and saws.

LINSINGER

Booth A5568
RAPTOR - Hydraulic-free into a Green Future



Thin-cut circular saws for mass cutting applications especially for the steel industry.

MultiCam Inc

Booth A4502
APEX5R CNC Router



Motion speeds exceeding 4,500 IPM, the APEX5R is a purpose-built aluminum fabrication machine combining new technology, design and craftsmanship.

ARCOS Plasma with 5 Axis Bevel



Arcos is designed for heavy plate fabrication providing fast, accurate, quality cuts. Adding bevel increases capabilities for weld prep, contour beveling, and your custom applications.

Remgrit Carbide Grit Cutting Tools

Booth A5123
BLU-MOL XTREME Quickcore Holesaw System

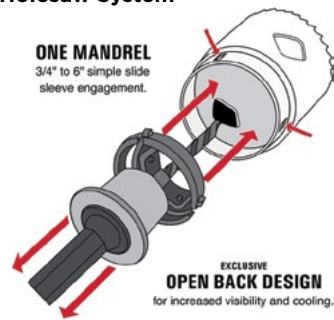

With 10x faster core ejection the BLU-MOL XTREME eliminates the #1 operator issue with holesaws. Quick and easy core removal and no extra tools are needed.

Simonds Saw LLC

Booth A5939
SBX GP



Bandsaw Blades 3/4" to 1-1/4" designed for general purpose and production cutting of bundles, tubes, and structural shapes. Used in steel service centers, medium and large manufacturers, fabricators, maintenance, job shops and tool and die shops.

TTEngineering

Booth A3554
TOP-S - 3D Laser Cutting Machine



3D cutting machine by TTEngineering designed to carry out high quality, precise cuts with a fiber laser process on pipes with a diameter range from 2.4" up to 30", a thickness range from 30 ga up to 10 ga and a maximum length of 100".

Vectis Automation

Booth B17054
Vectis Cobot Cutting Tool



The ease-of-use and flexibility of the Vectis welder is now available for Plasma Cutting. Program and cut 3D components, tube, and complex projections with ease.

Fastening & Joining

AKH Inc

Booth B29067
AKH Pre-Painted FAS-NER®



AKH Painted FAS-NER®, allows you to insert directly into pre-painted metal. The FAS-NER® color is matched to the color of your painted assembly allowing for the elimination of post-paint.

Finishing

Acme Finishing

Booth D45266
AAMA 2604 & 2605 Certified Powder Coater

Architectural powder coating line to coat parts up to 27 feet in length and 8 feet tall.

AFC Finishing Systems / Airblast AFC

Booth D45558
Containerized Blast Rooms

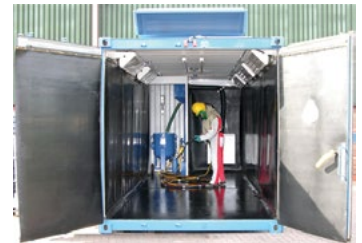

Airblast AFC containerized blast rooms provide an economical solution when a weatherproof and/or transportable blast room is required. This versatile, mass-manufactured, watertight enclosure is an ideal starting point for a blast room.

Air and Liquid Systems Inc

Booth D45057
CO2 Cleaning Systems

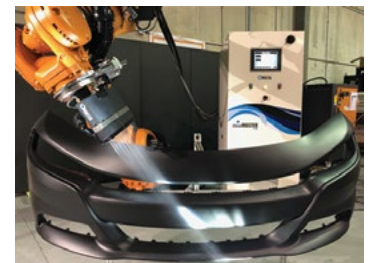

Non-aqueous cleaning and surface prep removes contaminants from plastic, composite, metal, and glass. Uses a fraction of the energy, material, and labor costs than conventional cleaning methods. Robot ready, environmental friendly, widely accepted.

Alliance Manufacturing Inc

Booth D45626
ILSA Vacuum Degreasing Parts Washer



Alliance Manufacturing is an authorized distributor of ILSA vacuum degreasing parts washers. These systems are ideally suited for critical cleaning applications and those with tight cleanliness specifications, using self-contained modified alcohols.

ARKU Inc

Booth A5538
EdgeBreaker® 6000



The EdgeBreaker® 6000 is designed for top quality manufacturers that process sheet metal after punching and laser cutting. Processing steps include; deburring, edge rounding and surface finishing, all in just a single machine.

CAPPLUGS / SHERCON

Booth D45634
Custom Rubber Masking Solutions



High-performing and precision-made products for a wide range of finishing applications. Custom rubber masking parts are

engineered to meet specific needs, and provide cost-effective solutions with short lead times.

Carlisle Fluid Technologies

Booth D45347
Binks Maple 120/3 Horizontal Pump

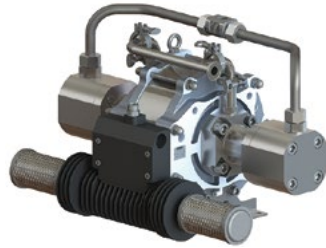

The Maple 120/3 Pump delivers flushing material to the rest of the plant. This high-flow 3:1 pump boasts no exterior leaking seals and low maintenance.

MS Elite Series

MS Elite Series is a high-quality coating with an easy-to-use, multifunctional powder cart system. Configurations includes single or dual applicators, vibratory box-feed or hopper, and a variety of cable and hose lengths.



Clear Label Masking Solutions

Protect part numbers, barcodes and other identifying markers during finishing processes with Caplugs new clear masking tapes and die-cuts. Fully transparent, barcode scanners and production operators can read labels clearly without any interference.

Caplugs is your masking expert. With a global footprint and local sales teams worldwide available for on-site visits, we respond to your needs quickly and efficiently.

- 13,000+ masking solutions – the largest standard product offering in the industry
- In stock and ready to ship today
- Free samples of all standard parts
- Custom made easy – quick lead times and cost-effective solutions

Product Protection | Masking Solutions | Custom Molded Components

- Injection molding
- Extrusion
- Rubber molding
- Vinyl dip molding
- Vinyl coating
- Die-cutting



www.caplugs.com/masking
 1.888.CAPPLUGS | sales@caplugs.com

Stop by Booth #D45634 for free samples.

Finishing

Chemical Coaters Assoc International

Booth D45362
Technical Manuals in Spanish



CCAI technical manuals are now available in Spanish and include Deseño de Sistemas (System Design), Pretratamiento (Pre-treatment), Recubrimiento en Polvo (Powder Coating), and Recubrimiento Líquidos y Equipos (Liquid Coatings and Equipment).

Industrial Finishing Online Courses



CCAI now offers online courses based on their popular technical manuals. The first of the seven-week courses include Powder Coating for Industrial Finishing Applications and Liquid Coating for Industrial Finishing Applications.

Circle-Proscro Inc

Booth D45375
Steelcote ZR-1



ZR-1 is a single-component, zirconium conversion coating specifically formulated for smaller system operators who need the corrosion resistance and paint adhesion of zirconium nanofilm

technology in a user-friendly product right sized for their process.

CS Unitec Inc

Booth B20049
KING-BOA™ All-Around Handrail Finisher/Polisher



Achieve professional finishes on handrails and pipes from 3/4" to 5" dia. KING-BOA™ has a wide variety of quick-change abrasive belts for 360° all-around blending, finishing, and polishing. Adjustable handle for use close to walls and in tight spaces.

Diamond H2O

Booth D45624
Turnkey Skid Mount Reverse Osmosis Systems

Engineered and pre-built complete water treatment systems from Diamond H2O. Ranging in size from 3.5 to 20 gpm.

Diamond Vogel Paint & Coatings

Booth D45758
T10 Super Durable CR TGIC Powder Coating



T10 powder coatings provide superior weatherability as well as innovative corrosion and chemical resistance demonstrated by 2500+ hours of salt spray resistance. When applied direct-to-metal, a one-coat painting process is possible.

EPSI Engineered Products and Services Inc

Booth D45020
Custom Plating & Paint Racks

EPSI's Racking and Hanging Division builds custom plating and paint racks to increase station density and maximize throughput. Custom hooks and wire forms are available in various materials to hang heavy and light products for bake cycling.

ESMA Incorporated

Booth D45649
E992 Automated Ultrasonic Passivation System



Esma Automated Ultrasonic Passivation System moves the fluids, not the parts.

Frohn North America

Booth D45047
Ox-Grit

Ferro-oxide abrasive for surface preparation applications.

Gema USA Inc

Booth D45337
OptiCenter® OC09 Powder Management System



Gema's OptiCenter OC09 Powder Management System is the solution for low to medium powder consumers seeking to improve powder utilization efficiency of their multi-color processes by eliminating multiple fluidized hoppers and reducing operator involvement.

Graco Inc

Booth D45333
E-Flo DCi



Graco E-Flo DCi direct current (DC) electric pumps with intelligent (i) control boost industry standards for high reliability, low maintenance and energy conservation.

Henkel Corp

Booth D45549
BONDERITE Sustainable Pretreatment Solutions



Solutions include BONDERITE S-AD HOT 22 HAPS-free paint stripper, BONDERITE M-NT Phosphate-free, cleaner/coater, BONDERITE M-NT zirconium based conversion coating and BONDERITE E-CO DMC control and monitoring equipment to reduce chemical usage.

Horizon Performance Technologies LLC

Booth D45156
Horizon Industrial Washer Technology



Capital equipment for the finishing systems and heat processing industries. Patented TORRENT (washing) and CYCLONE (dry/cure) technologies use 75% less water and kW resulting in superior metal performance tests.

Horizon High Efficiency Zirconium Filter System



The filter media can be sand or glass. The filter tank, pump, and controller are skid mounted. The variable speed pump can be controlled to a constant flow, automatically adjusting for varying operating conditions; or it can be controlled to a constant motor speed.

Horizon Water Treatment System with RO



Water Treatment System with Reverse Osmosis – the Complete Water Treatment System includes carbon filter, FRP tank, brass control valve for chlorine removal, duplex water softener, FRP tanks, water meter, salt tank with salt grid and safety shutoff float and more.

Horizon Oil Coalescer 6000



Oil Coalescer 6000 – the unit is located next to the washer and works in a side stream fashion, drawing a water/oil mixture off the top using a floating head and diaphragm pump.

Horizon Industrial Oven Technology



The CYCLONE Oven-System generates uniform oven temperature curves utilizing up to 75% less energy.

Horizon Spare Parts and Service



Countless options for any future service, retrofit or upgrade required for gas trains or equipment.

IFS Coatings Inc

Booth D45537
IFS PureClad Powder For Wood & MDF



Powder for non-metal substrates delivering a beautiful, tough, flexible finish, with exceptional performance, with a quick, efficient application process.

IST International Surface Technologies

Booth D45030
Robotic Sandblasting Systems



ISTblast's Robotic Sandblasting Systems allow you to automate your surface preparation and treatment process with the precision of a robotic arm. The process controller can run several programs to accommodate a large variety of parts.

Keyland Polymer UV Powder LLC

Booth D45541
UVMax® Defender

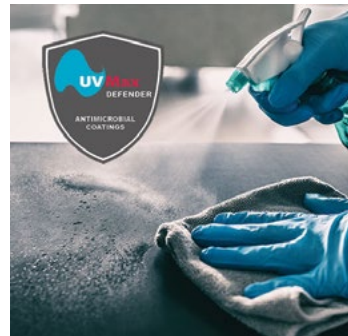

UVMax® Defender antimicrobial UV powder coatings utilize Bacti-block silver ion technology. After

24 hours, surfaces coated showed the reproduction of E. Coli and Staphylococcus microbes were reduced by more than 99.99%.

LestaUSA

Booth D45368
Pulver Control Powder Flow Sensor



Monitor automatic powder guns and display actual flow of powder in real time. Sensors work with DeGeest software to bring peace of mind by sending email/text warnings and stopping the line before expensive rework if your guns are not working optimally.

Nitrotherm® Spray



Patented technology for constant humidity and temperature control for consistent application conditions all day, in all seasons. Reduce overspray + generate 20%-30% savings of coating materials. Works with existing equipment and is distributed by DeGeest.

POLIFLUID®



Generates 10-30% savings of powder + increases production line speed. Works with existing equipment. Distributed by DeGeest.

Finishing

LestaUSA Self-Learning/3D Scan



Hybrid robotic painting system that brings together Lesta's self-learning robots and 3D scanning. Combining benefits of a robotic program created by your best painter with 3D scanning technology allows programs to match variable part locations.

LISSMAC Corp

Booth A4924
SMD 335 REE & SMD 335 DRE

The SMD 335 REE is built to deburr and provides edge rounding radius of 2mm. The SMD 335 DRE is designed to chip, slag, grind and edge round plasma cut parts.

LPI Lift Systems

Booth D45543
LPI Boost Lift



LPI's Boost Lift, a one-person self-propelled pneumatic elevating work platform is drivable at full height. The Boost provides ergonomic maneuverability at your fingertips, offering a safer way to reach and reposition while working at heights.

LS Industries Inc

Booth D45151
**Monorail Shot Blaster
 MONO4884**

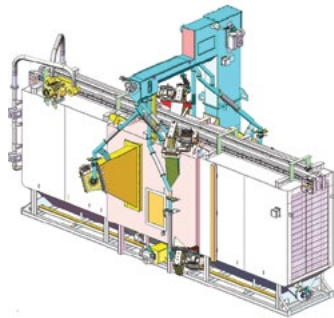

State of the art monorail technology driven by the LS Industries HMI system and includes a forced maintenance program.

Michigan Pneumatic Tool Inc

Booth B22006
1500 Series of 1.5hp Grinders



MPT's 1500 Series of die, wheel, cone and belt grinders offers a powerful 1.5hp governed motor for greater performance and productivity. The durable steel housing makes them ideal for intense metal working applications. Available from 9000 to 18000 rpm.

Midwest Finishing Systems

Booth D45529
Turnkey Finishing Systems



Midwest Finishing custom finishing systems, including pretreatment washers, dry-off and cure ovens, environmental rooms, and material handling solutions. Features include modular design, quick installation, custom controls, and energy savings.

Mighty Hook Inc

Booth D45643
Angle Pivot Tooling System

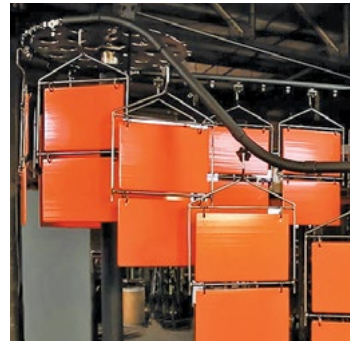

The patented Angle Pivot Tooling System is a customized tooling and hanging solution that gives you higher output, better first-pass transfer efficiency, better in-plane part tracking, more accurate thickness control and increased safety.

Nordson Corp

Booth D45325
coatmaster Flex



Correct deviations in your coating application immediately. coatmaster Flex will eliminate rework before the product is cured. Ultimately helping our customer save on material costs and ensure a quality finish every time.

Parker Engineering of America

Booth D45129
Parker Proficiency



4th generation, version of the Pulse Power® Advanced Corona Charging Technology, the Parker Proficiency. The System features gun mounted control of powder output as well as a full line purge control.

Powder Coating Institute

Booth D45032
Powder Coating: The Complete Finisher's Handbook



Fully revised and updated by powder coating experts, the Fifth Edition reflects advancements in technology and is a comprehensive guide to the entire powder coating process.

PPG

Booth D45132
PPG ENVIROCRON™ Extreme Protection Edge Powder

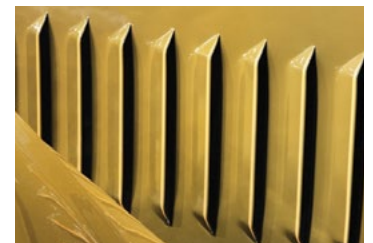

PPG ENVIROCRON™ Extreme Protection Edge powder delivers edge corrosion protection in just one coat. Formulated to cover sharp edges, this powder provides coverage that surpasses standard one- and two-coat powder systems.

Production Plus Corp

Booth D45526
Magic Rack III

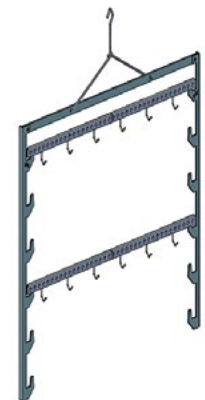

The Magic Rack III features an easily adjustable crossbar system to fit a variety of medium and small parts, internal grounding to cut down on cleaning costs, and works with any Magic Rack hook.

Richards-Wilcox Inc

Booth D45524

Self Leveling Carrier

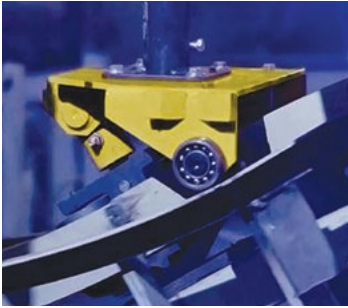

Self-leveling carrier for inverted conveyor finishing systems.

Sames Kremlin

Booth D45356

InoBell® Powder Bell Applicator

INO BELL®
POWDER BELL APPLICATOR
HIGH PERFORMANCE SPRAYER



A high transfer efficiency powder applicator that delivers: higher first pass transfer efficiency, better uniformity, and high finish quality.

Manual Airspray FPro Gravity, GSP & Smart Cups



Manual Airspray FPro Gravity, GSP, and Smart cups disposable cups. The FPro Gravity is available in HVLP, LVLP and Conventional technologies.

Inocoat Manual Powder Systems Range

A complete range of manual powder systems called the Inocoat Powder range. The signature of this new range is TEC5 technology that sets new standards and references of the electrostatic performance.

Scientific Industrial Nano Engineering - SINE

Booth D45851

Spiral Stack Pump

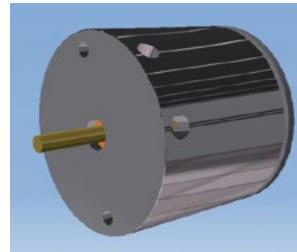

The spiral stack pump is a reversible, high-pressure, pulsation-free, laminar flow pump for viscous fluids. This versatile, bulletproof design eliminates the pressure spikes of piston, peristaltic, and scroll pumps, preventing damage to media.

Sherwin-Williams

Booth D45766

Powdura® ECO Powder Coatings

This transformative product collection elevates powder coating sustainability by utilizing recycled plastic - providing customers a more eco-conscious solution to product protection, color and performance.

Sistem Teknik Makina San Ve Tic AS (Electron)

Booth D45045

MASTER MODEL Powder Coating Equipment



Holds 50 different recipes and recipes can be switched with double triggering on the gun. The unit has 3 default presets namely straight surface coating, secondary layer coating, and tough surface coating.



MICHIGAN PNEUMATIC TOOL



Visit Us at
Booth B22006



MP-1518DGS-C4

Introducing the MP-1500 Series Grinders

The MP-1518DGS-C4 is just 1 of the 96 possible variations on our 1500 Series of die, wheel, cone and belt grinders. The 1.5 hp governed motor of the MP-1500 Series die grinder offers unparalleled power and performance. The durable all steel housing makes the 1500 Series ideal for demanding metal working applications. Pick the perfect speed for your abrasive, as the MP-1500 Series is offered in speeds of 9,000, 12,000, 14,000 and 18,000 rpm. The MP-1500 Series of grinders is offered with a side exhaust or a front exhaust option is available on non-extended collet models. Collet options available in 1/8", 3/16", 1/4", 5/16", 3/8", and 6mm.

1-800-521-8104

www.michiganpneumatic.com



Finishing

Sprimag Inc

Booth D45063
S-703MD



The S-703MD Spray Gun Generation offers higher productivity and improved coating application equipment quality thanks to immediate spray jet formation. Better material flow adjustment with the nozzle extension, and optimized circulation resistance in the paint tube.

Trimac Industrial Systems

Booth D45224
Mini-Mobile Powder Coating



The Mini-Mobile System is a compact and portable finishing system to coat and cure parts. Includes an electric infrared oven, powder booth and manual trolley system so you can roll-in, plug-in and have cured parts typically in 5 minutes or less.

Gases & Gas Equipment

WITT Gas Controls

Booth B36021
"SMART" Safety Product



WITT Dome pressure regulator and safety relief valve with integrated digital sensor technology, measures gas pressures and the gas temperatures.

Inspection & Testing

Accurex Measurement Inc

Booth D46368
TubeInspect P16.2 & P8.2 HRC



HRC (High-Resolution Camera) option provides a 4x higher resolution than the previous TUBEINSPECT.

DeFelsko Corp

Booth D45140
PosiTector Gage Body



PosiTector gage body features a larger 2.8" impact resistant color touchscreen for quick menu navigation with or without gloves, new ergonomic design with a durable rubberized grip for comfortable all-day inspection, an updated modern user-interface, and on-gage help to explain menu items at the touch of a button.

Elcometer Inc

Booth D45551
415 Coating Thickness Gauge



The Elcometer 415 Paint and Powder Thickness Gauge provides simple, fast, and accurate coating thickness measurements

on smooth and thin paint and powder coatings. Available for measuring coatings on both ferrous and non-ferrous metal substrates.

Hexagon

Booth A3326
Absolute Scanner AS1

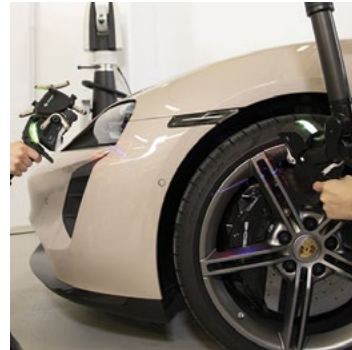

The Absolute Scanner AS1 is the flagship 3D scanning sensor for Absolute Tracker AT960 and Absolute Arm 7-Axis systems, it combines 'always-on' maximum performance with simple usability to deliver high-productivity non-contact 3D measurement.

Magnetic Analysis Corp

Booth D46474
Rotomac® 25RM Eddy Current Rotary



Rotomac® 25RM eddy current rotary, designed for use in slow throughput operations such as cold headers in fastener production, spring makers and other parts manufacturers.

Oasis Scientific Inc

Booth B13058
ViTiny UM10 HDMI/USB Autofocus Microscope



ViTiny UM10 HDMI/USB Autofocus Digital Microscope can output to a Windows PC and TV monitor at same time. With UM10, the end user can save pictures and videos on the SD card.

Toledo Integrated Systems / Toledo Transducers

Booth D46758
RAM VIEW



Ram View is used to display the press shut height position. Soft high limit, soft low limit and run tolerances are included. Position shown in inches or metric (mm). Calibration is made easy with on screen instructions.

ViewTech Borescopes

Booth B20066
ViewTech Borescopes Inspection Video Borescopes



ViewTech Borescopes VJ-3 articulating video borescopes are used during remote inspection of machinery, equipment and components.

W Abrasives

Booth D45756
WA Clean

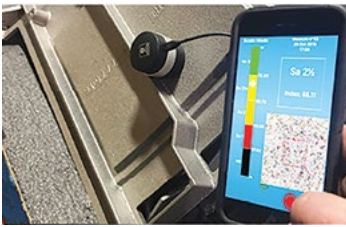

WA Clean Technology are unique, reliable and cost-effective tools to measure surface cleanliness.

Xiris Automation Inc

Booth B17040
XIR-1800 Thermal Camera



High Dynamic Range SWIR thermal camera designed for use in metal welding and Additive Manufacturing applications that provides enhanced imaging beyond what is visible using standard thermal or visible-light cameras.

Job Shop/Contract Manufacturing

Decoral System USA Corp

Booth D45249
Powder Coating + Sublimation



Decoral decorative finishes can take your products to the next level offering beauty, long-term protection and durability.

Valmont Coatings

Booth D45271
Pittsburgh Galvanizing



Valmont Coatings newest and "greenest" galvanizing facility in Midland, PA. Pittsburgh Galvanizing is equipped with a 54' long kettle and features our new, environmentally friendly VAL-PREP™ cleaning and VALPASS passivation processes.

Lasers

Aimtek Inc

Booth B18071
Scan Head Laser Welding Systems



Scan Head Laser Welding Systems from K-Lab are now available in the US through Aimtek, Inc. Scout is an advanced, precise, and easy to use scanning solution and features automatic repositioning and a smart vision system for repeatable welds.

Alpha Laser US

Booth A3508
ALFlak Fiber Laser Welding System

The ALFlak laser system for deposition and contour welding allows you to make repairs and modifications or produce in series, you can effortlessly process sheet metal, aluminum, stainless steel and sectional steel.

Amada America Inc

Booth A2104
VENTIS 3015 AJ Fiber Laser



VENTIS utilizes Locus Beam Control (LBC) technology to create infinite locus patterns - ensuring optimum beam shape for each cutting application. This results in the highest quality cuts on stainless steel and aluminum with virtually no dross.

ENSIS 3015 AJ (12kW) Fiber Laser



The 12kW ENSIS fiber laser utilizes an innovative collimation system so fabricators can process thin-to-thick materials without a cutting lens change or manual setup.

EML 2515 AJ Fiber Laser/Punch Combination Machine



AMADA's most popular combination machine pairs a multi-purpose turret with the unlimited shape cutting flexibility of a fiber laser. This grants fabricators the flexibility to work with their customers to create better part designs.

BREVIS 1212 AJ Fiber Laser



The BREVIS 1212 AJ 3kW fiber laser provides the versatility of a production quality laser in a compact design. This machine features high-speed processing, easy material loading, and a rotary index to process tube or pipe.

Bystronic Inc

Booth A2126
15kW ByStar Fiber Laser Cutter



The ByStar 15kW Fiber laser cutting machine cuts steel, aluminum, and stainless steel from 20 gauge up to 1.500 in thick, and brass and copper up to .750 in thick with high precision.

Next Generation BySmart Fiber



The Bystronic Next Generation, high-performance BySmart Fiber laser, with new 10kW power source, combines high-value performance with an affordable price for high parts output and excellent cutting quality across thin to medium sheet metal thicknesses.

Coherent Inc

Booth B15035
HighLight™ FL-ARM High-Power Fiber Laser



Advanced fiber laser technology for effectively welding delicate or heat-sensitive materials, dissimilar materials, and even copper.

Mazak Optonics Corp

Booth A4402
OPTIPLEX NEXUS 3015 FIBER S7



The OPTIPLEX NEXUS 3015 FIBER S7 is a 2D flying optics fiber laser-cutting system from Mazak Optonics and is designed with groundbreaking Variable Beam Parameter Product (V-BPP) technology that better controls the laser beam for superior cut performance.

Lasers

Mitsubishi Laser, Press Brake, & Automation – MC Machinery Systems, Inc.
Booth A2923
GX-F ADVANCED Series



User-friendly, smartphone-like controls and high processing stability with superior beam-quality consistency. Beam cleaning and anti-back reflection technology and faster and more stable processing.

Muratec
Booth A4901
LS3015HL 6.0kW



This multi-functional fabrication machine combines fiber laser cutting and forming into a single, highly-reliable production center. Leveraging the high-speed precision of fiber laser cutting and the accurate forming and tapping.

RDI Laser Blanking Systems
Booth A3350
Coil-Fed Laser Blanking up to 0.25" Thick Material



RDI Laser Blanking Systems now support materials up to 0.25" thick on their coil-fed laser blanking technology.

Superflash Compressed Gas Equipment Inc
Booth B33057
LaserCore



LaserCore® is your destination for nozzles, ceramics, and holders. We provide high quality products and customer service with low cost for major fiber or CO2 laser cutting systems.

TRUMPF Laser Technology
Booth B18005
TruLaser Station 7000



The new TruLaser Station 7000 can handle all the most common metals including mild steel, stainless steel, copper, aluminum and titanium, as well as plastics.

TruMark Station 5000



The compact TruMark Station 5000 comes equipped with linear axes in the X, Y and Z direction and rotary axes with various clamping systems, to meet your requirements.

TRUMPF North America
Booth A2904
TruLaser 5030 Fiber



The TruLaser 5030 fiber 12kW impresses with its high processing speed and reproducible, high part quality - even for complex contours. Smart features make the complete cutting process more productive and more reliable than ever.

Machining/EDM

VOLLMER of America
Booth D46466
Loroch Evolution K850-M



The Loroch Evolution K850-M is an efficient and powerful service center for small to medium sized companies to grind metal cutting circular saw blades.

Maintenance & Repair

Durable Blast Parts LLC
Booth D45858
www.durableblastparts.com

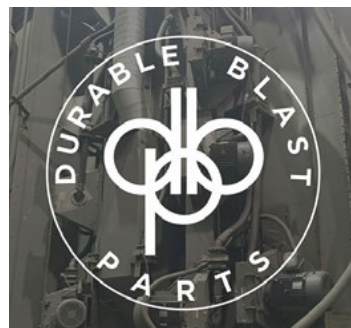

An enhanced e-Commerce store for purchasing abrasive blast machine wear parts and components equal to or better than OEM quality.

Material Handling/ Marking

AGT Robotics
Booth B20045
LayoutMaster



With full-color projection, the LayoutMaster can project: part 3D contours, holes, hole centers, welding information, part numbers and much more.

Bunting-Newton
Booth A5141
MagSlide Conveyor



MagSlide® magnetic chip conveyors are built to handle your toughest conveying jobs. Designed for the most punishing jobs, the unique magnetic conveying system present in the MagSlide conveyor provides trouble-free operation.

Design Storage & Handling Inc
Booth D45943
Hubtex Maxx

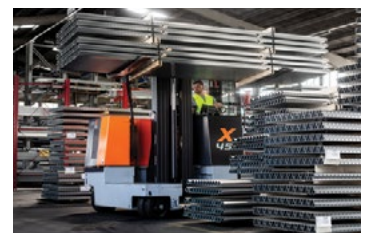

HUBTEX MaxX is an indoor/outdoor electric multi-directional sideloader. The MaxX delivers innovation, safety, and enhanced ergonomics thanks to its modern design.

EMH, Inc
Booth A3477
Lightweight AL System™ Lamp Post Cranes



EMH AL System™ Lamp Post Workstation Cranes are flexible and versatile, expanding workstation flexibility with more workstation placement solutions for convenient access for optimum efficiency.

Fehr Warehouse Solutions Inc
Booth A5007
Fehr Ecosort



With up to 120 picks per hour, Fehr Ecosort is the fastest sorting system for long goods.

Fehr Honeycomb - Steel Distribution Center

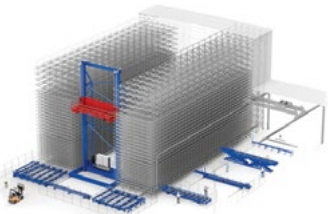

Optimize your steel distribution center performance, reduce risk and overhead.

Fehr Honeycomb for Window and Door Manufacturers



Fehr Honeycomb allows for storing aluminum, vinyl or wood profiles in bundles, individual extrusions or load carriers.

Fehr Honeycomb

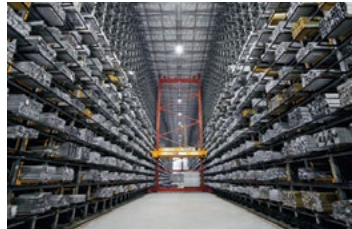

Store the greatest amount of goods in the smallest possible space.

Fehr Retrofit

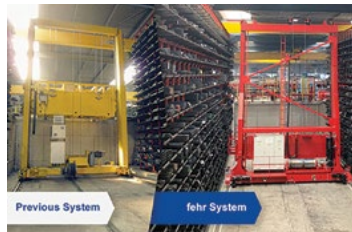

Retrofit your existing AS/RS system.

Fehr Multi Tower



Fehr Multi Tower offers warehouse solutions regardless of product or industry. Optimal space utilization, maximum availability.

Gorbel Inc
Booth A3518
G-Force Q2/iQ2



The Gorbel®'s G-Force® and Easy Arm® Intelligent Lifting Devices use exclusive patented technology and an industrial processor controlled servo drive system to deliver unmatched lifting precision and speed.

Sideros Engineering
Booth B21049
Spaziomatic



Spaziomatic Vertical storage is an automated storage and retrieval system for sheet metal, tubes and bars. Spaziomatic features an elevator to deposit and retrieve drawers and deliver them directly to the load/unload bay at a safe working height.

Therma-Tron-X Inc
Booth D45351
TTX Automated Conveyor Carrier (TTX ACC®)

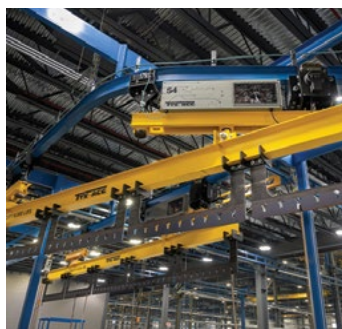

TTX's ACC® is an overhead conveyance system that consists of

automated carriers that provide reliable and consistent point-to-point movement of everything from small parts to heavy parts.

Zerust Corrosion Solutions
Booth D47552
Z-PAK® VCI Packets



Zerust® Z-PAK® is an economical, effective, and easy-to-use VCI diffuser packet that can be used alone or, with other Zerust® packaging products to provide robust corrosion protection for ferrous metals during shipment, storage, or work-in-progress.

Other Machinery/ Equipment/Parts/ Products

AEREM Industrie Inc
Booth D45750
uCube

The uCube filter is a new approach to high paint consumption spray booths reducing up to 10 times maintenance costs due to its very high loading capacity up to 40lbs per 20" x 20" pad with a filtration efficiency reaching 99+%.

AIS Finishing Systems
Booth D45256
Zirconium Pretreatment Filtration System



AIS is now providing its customers with a Zirconium Filter used in conjunction with the Zirconium Pretreatment System for powder, liquid, and e-coat operations.

PREPARE TO BE AMAZED

LightWELD™ 1500

HANDHELD LASER WELDING

 **FABTECH**

VISIT US AT **BOOTH #B27038**



FASTER & EASIER
Than Traditional MIG & TIG



LEARN MORE
ABOUT
LIGHTWELD

Discover why seasoned professionals are calling LightWELD the **most revolutionary welding system** available.



PHOTONICS®

For more information, visit HandheldLaserWelder.com or call +1 877.474.7468

**Other Machinery/
Equipment/Parts/
Products**

ASC Machine Tools

Booth A3462

TKR-X™ Purlin Rollforming Line



TKR-X™ Rollformer offers the highest level of flexibility: manual, semi-automatic or fully automatic. The TKR-X™ Modular Punch Press uses a combination of 4-Post and CEE-Frame Die Sets to guarantee highest throughput speeds.

Bissell Commercial

Booth A5124

US-5 Compact Battery Sweeper



Heavy duty design for all types of sweeping both indoor and outdoor. Battery operated with vacuum suction for impressive dust control and maneuverability.

**Blast Cleaning
Technologies**

Booth D45547

M5A TwistLOK e-Wheel



M5A is the next evolution of the popular M5 wheel. Threadless end liner retention, improved end and top liner sealing, and reduced parts count make for an easy to install and maintain blast wheel.

Chase Cooling Systems

Booth A3556

QBL & CWL Series Chillers



QBL and CWL Series serves the laser industry with a range of 2-17.5 tons. Each unit comes with two independent cooling circuits and the compact footprint of a single unit. CWL Series units have optional UL-certified control panel.

Emmegi USA Inc

Booth A5127

COMET R4



CNC machining centre with 5 controlled axes cantilever structure and full guarding for machining bars or workpieces made of aluminum, PVC, light alloys in general or steel up to 4 m long.

Midwest Automation

Booth A5306

Modular Design Deburring & Finishing Machines



Modular design, cartridge-style platforms for wet or dry metal deburring, deslagging, edge rounding, laser oxide removal and finishing using common platforms and cartridge-style abrasive head assemblies.

**OZEN Compressed Air
Technology**

Booth A3550

OABC D Compressed Air & Nitrogen Booster



A rotary screw, variable speed drive booster that delivers 71-268 CFM at 580 PSI. This product has a long service life and low maintenance cost.

**Sumner A Southwire
Company**

Booth B37024

LCS11, 11" Locking Clamp with Swivel Pads



Provides flexibility for clamping a variety of shapes. Swivel pads provide a larger and more stable grip surface. These pliers feature spring-loaded handle action, a trigger release for maximum locking force, and strong riveted connecting arms.

T. J. Snow Company

Booth B28012

Water Chillers

**INDUSTRIAL
WATER CHILLERS**

1/2 ton - 200 tons
Ready for Shipment!



Versatile industrial water chillers from Industrial Process Cooling (IPC) for a wide range of applications. T. J. Snow stocks 1/2 ton to 20 ton, and larger sizes are available up to 200 tons.

Titan Catalytic

Booth D45672

Titan Gas Catalytic Ovens and Heater Panels

**TITAN
CATALYTIC**

Gas catalytic infrared equipment for the finishing industry to cover powder and liquid applications. Heaters and catalytic ovens including pre gel, booster, dry off ovens, and full cure ovens are custom designed.

**Tsunami Compressed Air
Solutions**

Booth D45275

**Dust Collector Regenerative
Dryer**



Tsunami's drying technology is configured specifically for dust collectors to offer a clean air package for maximizing system performance and reducing operating costs.

Plate & Structural Fabricating

Akyapak USA

Booth A2174

AKYAPAK ARTOS CNC Gantry Milling Machine



Designed for use in heavy machining operations, ARTOS stands out with its precise positioning capability in X and Y axes and its fast and automatic tool change feature compared to models in this class.

Bendmak Machinery

Booth A5738

Plate & Angle Rolling Machinery

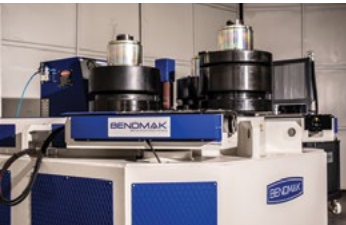

Bendmak offers the finest selection of plate, angle and structural processing machinery.

HAEUSLER AG Duggingen

Booth A5338

Solution for Rerolling Cones



This solution from HAEUSLER is based on adapting a 3-roll bending machine in such a way that a conical tube can be brought to a stable position that prevents "wandering" during the calibration process. In this process, the optimal roll positions are automatically calculated by the machine after entering the cone parameters.

Peddinghaus Corporation

Booth A2163

Anglemaster-663



The Anglemaster-663 caters to today's fabricators' need to automate punching, shearing and marking for angle and flat bar.

HSFDB-2500/3C - High Speed Plater Processor



Powerful drilling technology, material handling efficiency and superior design make the HSFDB-C the competitive edge of plate fabricators all over the globe.

Press Brakes

Amada America Inc

Booth A2104

HRB 1003 ATC Press Brake w/ Automatic Tool Changer



The latest advancement in press brake technology combined with AMADA's patented Automatic Tool Changer (ATC) enables you to perform even the most complex tool setups in less than 4 minutes.

HRB 8025 Press Brake



The HRB Series of Press Brakes leverages AMADA's latest bending technology and a variety of production-enhancing features to provide an outstanding price/performance ratio.

EG 4010 Press Brake



The EG 4010 is a compact, all-electric press brake that provides the ideal solution for producing small sheet metal components that demand a high degree of precision.

Automec Inc

Booth A3262

CoastOne Servo-Electric Press Brakes



CoastOne Servo-Electric Press Brakes offer extremely high accuracy and repeatability (+/- 0.00008"). They use a direct drive system and no hydraulics whatsoever. Machines range from 3 ft., 25 tons to 13.5 ft., 150 tons.

CNC600 Control



Automec's CNC600 control is a 15" touch screen display offering features such as tool library, job preview, angle mode, USB backup, unlimited storage, importing photos, and more.

Bystronic Inc

Booth A2126

Xpert Pro Press Brake



Xpert Pro meets the highest demands in terms of process speed and flexibility. Three models are available and fabricators can accessorize and adapt to their requirements on a modular basis.

ERMAKSAN / ERMAKUSA

Booth A4414

ERMAKSAN FX Series Servo Electric Press Brake



Press brake, offering fast and environment friendly bending solutions. Belt technology eliminates the need for crowning on the bed and comes with 3D graphical touchscreen controller and offline software.

Press Brakes

Pacific Press Technologies
Booth A3426
Machine Upgrades/Retrofits



Pacific's machine upgrade programs increase the performance of your existing equipment. Whether you want to add CNC to an aged mechanical machine, increase speed, or upgrade controls, packages are available for every need. Backed by our Retrofit Warranty.

Revolution Machine Tools
Booth A2788
RMT B-GENIUS-H 14-250 Hybrid Press Brake



B-GENIUS-H is RMT's hybrid press brake which provides accurate bends even for small parts. Standard 4 Axis, 8'-13' bending lengths, 110-300 Tons.

TRUMPF North America
Booth A2904
TruBend 5170



The TruBend 5170 is equipped with TRUMPF's newest generation ToolMaster which minimizes changeover time, increases productivity and lowers cost per part. It can also automatically load standard, ACB Wireless, and custom tooling.

TruBend 7050



The TruBend 7050 bends with a press force of 55 tons and has a bending length of 60 inches. The ergonomic high-speed machine's 6-axis backgauge guarantees exact positioning of components with remarkable precision.

Wila USA
Booth A3120
WILA AirPower Series

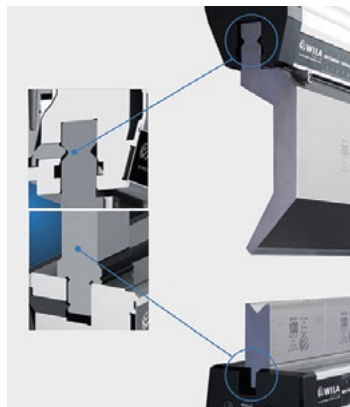

Tool up with the WILA AirPower Series. The complete range of WILA's pneumatic tool holders, top and bottom, pro and premium. Speed up operations and tool changes — and maximize productivity.

WILA Hemming Series

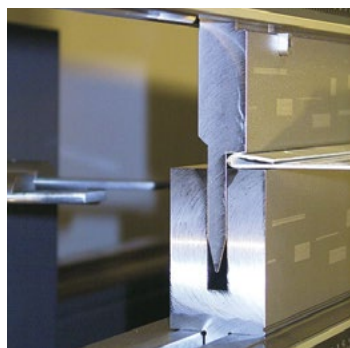

WILA offers a full range of hemming solutions to fit your needs. Depending on what material thicknesses and how frequently you hem, WILA has the solution.

Punching

Replacement Brush Tables
Booth A3288
High-Wear Punch Press Brush Panels

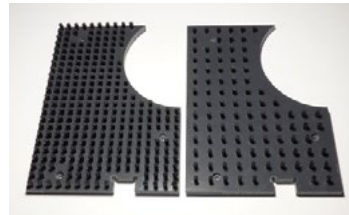

OEM-quality high-wear designs that prolong the life of each brush panel.

TRUMPF North America
Booth A2904
TruMatic 3000 Fiber



The TruMatic 3000 fiber is the first combined punch-laser machine from TRUMPF to feature a control panel with a Touchpoint interface. This machine also pairs a "flying" delta-drive punching head featuring all-tool rotation with a 3-kilowatt TruDisk laser.

Resistance Welding

Portwest LLC
Booth B25070
Portwest FR21

This coverall is perfect for the extra warm weather demands of the offshore industry. Constructed with a lighter weight highly innovative flame-resistant twill fabric.

T. J. Snow Company
Booth B28012
Online Resistance Welding Training

Online resistance welding training in the form of live, virtual seminars. These seminars can be customized to fit the applications of your company.

WeldComputer
Booth B25069
WeldComputer WeldRemote™ Management System



WeldComputer's WeldRemote™ Management System alleviates the need for support personnel to travel to different resistance welding installations. Now, manage welding operations remotely from anywhere in the world with internet access.

Robotics

ABB Robotics & Discrete Automation
Booth B17038
GoFa™ Collaborative Robot



The 6-axis GoFa™ CRB 15000 is designed to support the growing demand for a collaborative robot capable of handling heavier payloads to enhance productivity and flexibility.

Abka Yazilim Otomasyon Ltd Sti
Booth B12034
Agen Duo - Robotic Structural Steel Assembler

Robotic structural steel assembler helps to maximize productivity - assemble, tack and weld.

ACCUFACTURE LLC

Booth B12036
ACCUTASK 2.0 Series



Mobile robotic workstation that is easy to move around the factory and easy to setup. No code programming and has everything needed on board, air, valves and I/O connection. Can be equipped with your favorite brand of robot.

ATI Industrial Automation

Booth B23036
AOV-10



Axially-compliant robotic orbital sander.

Harmonic Drive LLC

Booth B12032
HPN-L



Face-Mount Value Series Planetary Gear. HPN-L Harmonic Planetary® value series gearbox provides a low cost solution without the need to compromise on quality or performance.

HGG Profiling Equipment Inc

Booth B35062
ProCutter 900RB

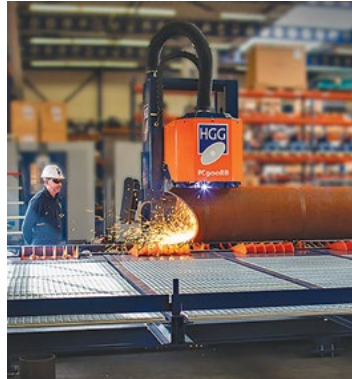

Along with an ability to accurately cut precision profiles from 2 to 36-inch diameter, pipe up to 42 feet in length, and an affordable price, HGG's ProCutter 900RB Series integrates a totally automated material handling system on a small footprint.

Kawasaki Robotics (USA) Inc

Booth B17048
RS013N



The RS013N builds on the momentum started by the RS007N/L model by offering a 13 kg payload capacity, small footprint and flexible, IP67-classified design, ideal for practically any general application.

Mid Atlantic Machinery Automation

Booth A3187
Robotic Modular Fabricator Package



Unleash the power of collaborative robots into fabrication shops with the Robotic Modular Fabricator Package.

OTC DAIHEN Inc

Booth B27021
JoyPEN Joystick Pendant



The JoyPEN joystick pendant ushers in a new age of industrial robot operation and programming. Lightweight, one-handed, game controller simplicity delivers intuitive operation and faster programming of robot movement and the weld process.

FD21 Series II Robots

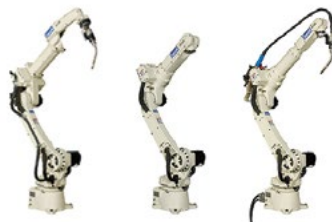

The B6Ls2, V8Is2 and V25s2 robots are the 8th generation (origin 1990) of 2+ meter reach robots. They are faster, lighter, slimmer, more repeatable and take up even less floor space.

FD21 Controller



The FD21 series, connected controller and teach pendant is equipped with the versatility to connect to your facilities, devices and users.

Synchro-feed Lite



Synchro-feed Lite is a simple, less expensive version of the ultra-low spatter, robotic welding technology. Advanced welding technology to reduce thin plate burn-through, deliver deep penetration with flat beads and reduce weld spatter by 98%.

Robotics

CoboWeld MIG Welbee



CoboWeld MIG by Melton Machine featuring OTC DAIHEN's Welbee advanced welding technology is a cobot welder for fabricators seeking the productivity of robotic arc-welding with the flexibility and ease of use of a collaborative robot.

FD-ST v3.0



Updated FD-ST, PC-based, off-line programming and simulation software to version 3.0 including more user-requested features, enhanced functionality and physical device support for the FD21 Teach Pendant or new JoyPEN joystick pendant.

ROTA-ARC 250 & 500



OTC DAIHEN has expanded the ROTA-ARC series of "H"-frame indexer/positioner style of production robotic arc-welding systems, to include the ROTA-ARC

250 and ROTA-ARC 500 variants. Headstock/tailstock positioning for your lower weight parts.

Peddinghaus Corporation

Booth A2163

PeddiBot-1200 - Robotic Plasma Coper



The Peddinghaus PeddiBot-1200 robotic plasma coper revolutionizes beam-cutting production.

PeddiAssembler - Robotic Beam Welder



The PeddiAssembler is the solution for steel beam assembly designed specifically to speed up one of the most time-consuming areas of the fabrication process.

Staubli Corp

Booth B15031

TX2 6-axis Robot Models



The TX2-140, TX2-160 and TX2-160L extend the current TX2 generation. Their rigid structure and smart design make them the ideal choice for a variety of applications ranging from harsh to sterile. They bring the highest level of safety and connectivity.

Yaskawa Motoman Robotics

Booth B20034

HC10XP Collaborative Robot

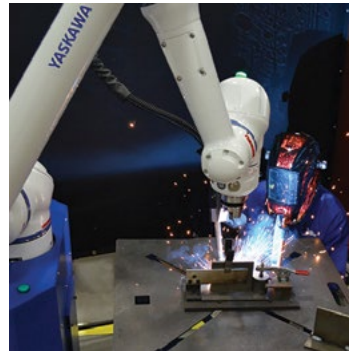

Designed to add collaborative robot welding capacity to current production, the HC10XP cobot is ideal for supplementing manual welding or for rolling up to large workpieces. Precision hand-guiding facilitates easy programming for fast implementation.

Safety & Environmental

ACT Dust Collectors

Booth B21004

LaserPack 4



Designed specifically for the laser cutting industry, the A.C.T. Dust Collectors LaserPack 4 laser cutting dust collection system provides a unique, heavy-duty and effective solution for removing fume, smoke, dust and other particles from facilities.

AirMax

Booth B35016

AirMax Dust Collector Filters & Parts



AirMax provides a premium selection of cartridge filters, high-efficiency industrial blowers, as well as cages and bag filters. The products are high quality and cater to a variety of applications. The right fit at the right price, right now guaranteed.

Bear Knuckles

Booth B27066

TIG Cowhide Welder Gloves



Bear Knuckles TIG welder gloves have a patented design that will give you better dexterity, improved grip, and high durability. Kevlar threads and reinforced leather gussets provide longer lasting construction.

Heraeus

Booth D45158

Soluva® Air W

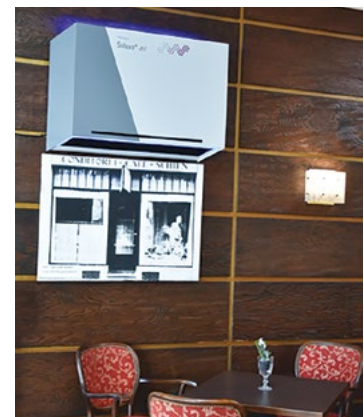

Soluva Air W purifies the air in smaller rooms such as meeting rooms and offices. Easy maintenance, no chemicals or filters needed for highly efficient UV-C (UVGI) air disinfection to avoid business disruptions due to employee infections.

Keller USA Inc

Booth A5146
AmbiWall



An ambient air filter system for welding fumes that doubles as a partition, noise insulator, tool storage, display board and more. This multi-functional, mobile unit keeps your employees safe while providing workspace flexibility.

Midwest Automation

Booth A5306
Niagara Wet Dust Collectors



Designed to efficiently clean or filter contaminated air in a variety of metal grinding, deburring or sanding operations that create metal dust and other abrasive media residue. Available in three series and 15 different models as well as compact models. Made in USA.

Nordfab Ducting

Booth A3336
Sealed Duct System Features



Nordfab's QFS sealed duct system is used for oil mists, cutting fluids, vapors and other wet contaminants collection. Used at each duct connection, the easier-to-install gasket is quickly wrapped around QF® duct's rolled edges for a secure fit.

Quick-Fit Visual® 3D Duct Installation Design

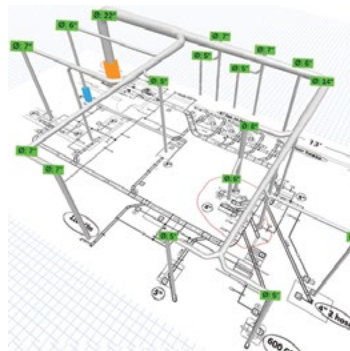

Quick-Fit Visual® is an easy-to-use, online tool for creating dust collection ductwork floorplans. QFV® provides automatic calculation of duct sizing and system requirements; quotes and 3D plans; installation documents; and .dwg drawings for use with CAD.

Ruwac Industrial Vacuums

Booth D45052
C201H2 Industrial Vacuum



Ruwac's Conductive Series C201H2 is a powerful and portable 110 volt industrial vacuum dust

collection solution designed for Class II Division 2 NFPA compliant combustible dust applications.

Steiner Industries

Booth B29062
0263 IronFlex TIG



IronFlex® TIG Premium Kidskin with Nomex® back TIG Welding Gloves - poly lined back, and adjustable cuff.

Saws & Cut-off Machines

CGW Abrasives

Booth B31017
eXtreme Cut Ceramic Cutting Wheels



CGW Abrasives' eXtreme Cut Ceramic Cutting Wheels are made up of a high performance sharp Ceramic grain specifically engineered for extremely fast cutting and a long wheel life.

Cosen Saws, North America

Booth A5331
V-1824



Manual vertical tilt-frame band saw.

Peddinghaus Corporation

Booth A2163
335-DGA Band Saw



Cutting on the 335-DGA double miter cut band saw is facilitated by a 3° attack angle. It is linearly guided with a rugged twin column design for fast positioning to miter sawing.

Revolution Machine Tools

Booth A2788
RMT S-GENIUS CS 16-16 Bandsaw



The fully automatic RMT S-GENIUS CS 16-16 bandsaw is optimized to work with carbide and bimetal blades and can be applied in areas such as steel trade, steel production, forging mills, machine manufacturing and automotive industry.

Ted Machines Inc

Booth A5021
Band Saw Blades



Ted Machines Inc. works with all major manufacturers world wide to deliver bandsaw blades.

Software & Machine Controls

Accurate Die Design Software Inc./Logopress

Booth D46649

Logopress ProgSim

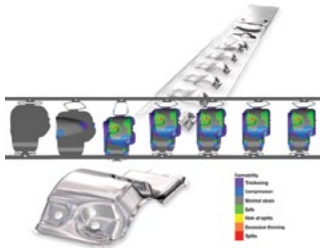

Logopress software that acts as a virtual press and enables progressive die designers working in SOLIDWORKS to efficiently simulate, modify, and validate strip layouts and allows for taking corrective measures in design.

FlashCut CNC

Booth A5109

Hi-Def Plasma Support



FlashCut CNC has full support for Hypertherm XPR, HPR and Kjellberg Smart Focus, HiFocus hi-definition plasmas. The intuitive interface is engineered for seamless access to all controls, commands and messages so you can cut accurate parts quickly and easily.

Hypertherm Inc

Booth A4449

ProNest Version 14.1

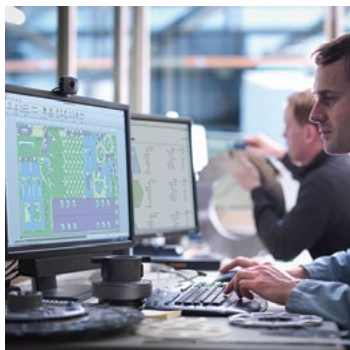

Version update to the ProNest® 2021, advanced CAD/CAM nesting software for automated cutting offering new features like undo/redo, drag leads, and search for jobs.

Rotary Tube Pro 3

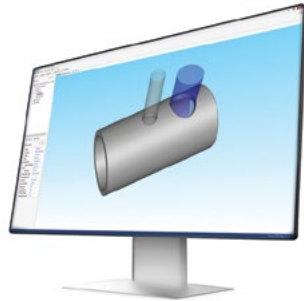

Rotary Tube Pro™ 3 is a major version update of its tube and pipe cutting software for machines with a rotary axis. This release contains new features and enhancements making it easy to design and cut tube parts.

New Forge LLC

Booth B12035

Augmented Reality Software & Smartglass Technology



As a TeamViewer Frontline Partner, we offer augmented reality software that revolutionize the daily work of the deskless workforce. By implementing AR technology, enterprises boast an ROI by increasing the productivity of frontline workers.

Schwarze-Robitec GmbH

Booth D45954

NxG Control System

Schwarze-Robitec's intelligent NxG control system brings users a huge gain in efficiency for their tube bending processes.

Wintriss Controls Group LLC

Booth D47335

ShopFloorConnect® OEE Software

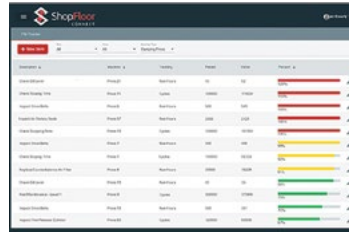

ShopFloorConnect® OEE Software features a PM Tracker enabling users to track important machine preventative maintenance (PM) items by run-hours or machine cycles, issue targeted alerts when an item requires PM, and track the maintenance work history.

SmartPAC PRO Press Automation Controller



The Wintriss SmartPAC PRO Press Automation Controller features advanced ProCamPAC PRO advanced Programmable Limit Switch, Advanced DiProPAC Die Protection features and more.

Stamping

AIDA-America

Booth D46527

NSX-1100



Up to 300 SPM, these 110-metric ton, unitized frame presses, have a stroke of 62 mm. Locally engineered for accuracy and high-volume production in automotive, appliance, hardware, and consumer goods markets.

Eagle Press & Equipment Co Ltd

Booth D47143

Eagle Product Line



Eagle Press offers a wide variety of stamping solutions and the engineering and manufacture of hydraulic, servo and gap frame presses.

Greenerd Press & Machine Company Inc

Booth D47138

2,500 Ton Hydraulic Compression Molding Press



Hydraulic press application solutions for a broad range of industries -- including a 2,500 Ton Compression Molding Press for rubber molding.

PUNCH INDUSTRY USA INC

Booth D47546

Bordignon-Brand Air Scrap Remover



The BRE Air Scrap Remover for progressive stamping dies offers an improved streamlined profile, lower air consumption and easy installation.

Revolution Machine Tools
Booth A2788
RMT H-SMART HSA550
Hydraulic Press



A single action press that can be used to bend, shape, hole punch, cut and straighten according to the die cut used. High precision machined frame and tables allow you to receive precise products in your production.

RMT H-FAB H (H-Frame)
Hydraulic Press



RMT H-FAB H presses are used mostly in repair and maintenance workshops for the small bending, punching, straightening, extracting/removing.

Wintriss Controls Group LLC
Booth D47335
Wintriss Online Store



The Online Store for stampers and metal formers provides a variety of die protection controls, connection hardware and sensors that have been carefully selected to deliver superior performance in metal stamping applications.

Tool & Die

Agathon Machine Tools Inc
Booth D47441
Guide System Plus



The Guide System Plus not only provides smooth action of the tool movement but also the highest accuracy/centering between the two tool halves, all in one unit.

Wintriss Controls Group LLC
Booth D47335
Advanced DiProPAC



With Advanced DiProPAC, Wintriss offers die protection features on the latest versions of its SmartPAC PRO Press Automation Controller. Over ten new capabilities have been added.

Wintriss Virtual Die Protection Clinic



Virtual Webinar version of the Wintriss Die Protection Clinic. For over 25 years, the Wintriss Die Protection Clinic has been the metal forming industry's source for die protection and in-die sensing information and training.

Tooling

Applied Robotics Inc
Booth B18008
UVP/UVH Self-Centering Vises



UVP is a pneumatically actuated 2-jaw self-centering vise. UVH is a hydraulic 2-jaw self-centering vise. Both have a compact design with a high clamping force and are available with a standard stroke, or long-stroke, or with one fixed jaw.

Fab Supply Inc
Booth A3574
Trumpf, RF-A, and LVD Style Tooling

Trumpf, RF-A, and LVD style tooling have met the highest standards and are perfectly interchangeable with the OEM tooling. All tools have a coating that inhibits rust from forming which results in better all-around tool performance.

Holemaker Technology LLC
Booth B17071
VersaDrive® Impact Rated Metal Cutting Tools



The patented VersaDrive® system by Holemaker Technology modular cutting system allows cutting tools to be used with impact wrenches and drivers as well as rotary drills like magnet drills and cordless drills.

Mission Tool & Machine LLC
Booth D47456

Clearing Try Out Press
1500 Ton coil fed try out press, 96 x 144 bed, Shut Height 60" over bolster.

Schwarze-Robitec GmbH
Booth D45954
All Electric Cutting Device

All electric tube cutting device which is directly integrated into the bending tool.

Vertically Adjustable Pressure Die
All multi stack bending machines by Schwarze-Robitec can be equipped with a vertically adjustable pressure die as an additional CNC axis

Tube & Pipe Fabricating or Welding

BLM Group
Booth A2935
LT8.20 5kW Fiber Lasertube



LT8.20 3D Lasertube advanced features and options include: Drill and Tap, Enhanced I-Beam Cutting Capabilities, High Pressure Dry Air Cutting, Sensorized Head Monitoring and 5kW fiber.

Tube & Pipe Fabricating or Welding

Bystronic Inc

Booth A2126
ByTube 130

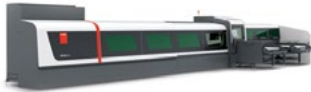

Available with up to 3kW Fiber laser power, the powerful, easy-to-operate Bystronic ByTube 130 delivers fast, flexible, and affordable laser tube processing for a wide range of material types and thicknesses in a fully automated workflow.

Carell Corporation

Booth A5314
ETM Series Tube & Pipe Benders

Heavy Duty Tube & Pipe Benders

ETM-HD Series
Digital HMI New Controls!



Includes Calculation Screens & Limit warnings. Up to 99 programs and impressive cycle times.

Bends up to 180° in one Step
Quick Change Tooling • Wide Range of Bending Radii:

ETM Series Tube and Pipe Benders new touch screens create up to 99 programs, each with a 5-stop sequence and automatic adjustment for springback. They have capacity-minimum radius calculators and limit warning screens.

ETM-80HD Heavy Duty Tube & Pipe Bender



ETM-80HD TUBE/PIPE BENDER
99 Bend Programs - Auto Cycle 2-1/2" Schedule 40 Pipe

Bends up to 180° in one Step
Quick Change Tooling • Wide Range of Bending Radii:
From 2" to 16" as tooling types permit

The ETM-80HD is the latest generation of tube and pipe benders. Built solid for high-performance bending of large diameter tubes on right or left sides with an easy-to-use programmable touchscreen that delivers years of reliable performance.

ACH Tube & Pipe Mandrel Benders



TUBE & PIPE MANDREL BENDERS
ACH SERIES

NEW!

Up to 5 Axis!
ACH-45 1-3/4" OD tube capacity
ACH-65 2-1/2" OD tube capacity

Line of "ACH" CNC Mandrel Benders including 2 Models, ACH45 1-3/4" and ACH65 2-1/2" with up to 5 CNC controlled Axis, servomotor controlled bend angle, DBB, POB, 2 stack former head plus hydraulic clamping and mandrel extraction.

H Series Tube & Pipe Benders



TUBE & PIPE MANDREL BENDERS
ETM-H SERIES

NEW!

ETM-60H 1-1/4" OD tube capacity

The ETM-H series semi-automatic bending machines perform bending automatically, while the feeding and rotation of the tube is performed manually. Providing a compact, high-performance and economical solution for any shop.

ITEC - Innovative Tube Equipment Corporation

Booth D45925
AMOB-eMob 100 All Electric Bending Machine



The AMOB - eMob 100 - 4" all electric 10-axis multistack CNC tube and profile bending machine now comes standard with direct drive electric bend head, carriage booster for 1xD and free form bending, vertical up/down CNC PDA, automatic spring back verification and correction and advanced CAD model based simulation software.

Dynobend 3D Freeform & Rotary Draw Mandrel Bending Machine



The Dynobend CB all-electric rotary-draw and 3D freeform bending machines for bending and rolling of tubes and profiles with ground breaking Dynobend FreeFormManager software allows the ability to download, bend and correct even 3 dimensional freeform parts through an automated algorithm that allows 2nd part correct part on even the most complicated of Freeform bent parts.

Starbend 800 3" Heavy Duty 2-Stack CNC Bending Machine



Re-envisioned Starbend electric CNC bending machines including a model 800 - 3" 2-stack 3-axis CNC bending machine.

Thoman CNC Profile Bending Machine, Est. 1981

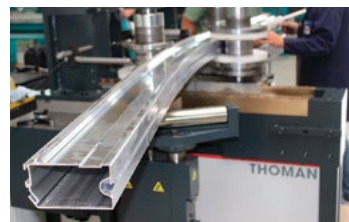

Manufactured in Germany since 1981, Thoman Biegemaschinen GmbH has a proven history of building some of the finest quality and most capable CNC profile bending machines in the world and we are very excited to be officially launching our exclusive partnership for the North American Market.

Manufacturing Solutions Industries Inc

Booth B37026
C6H ChamferMate® Pipe Beveling Machine

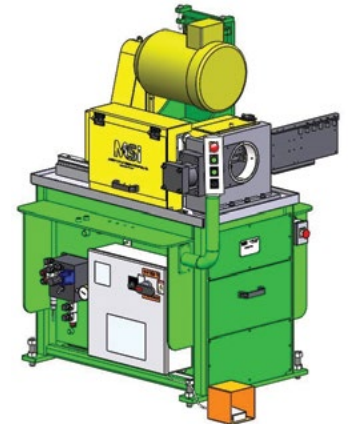

The Model C6H ChamferMate® is a heavy-duty, ultra-rigid pipe and tube beveling machine that is perfect for customers who focus on the 2" - 6" OD pipe range. The C6H is equipped with a 15-horsepower motor and provides 6" of stroke.

Midwest Automation

Booth A5306
Centerless, Polishing & Deburring Machines



RandBright (Dry/Wet) Centerless, Finishing, Polishing and Deburring Machines run a variety of abrasive belts, finishing wheels, wire brushes, and buffing wheels for grinding, finishing, deburring, brushing, and cleaning.

Revolution Machine Tools

Booth A2788
RMT Pipe Spool Master TGB14 CNC



RMT Pipe Spool Master TGB14 CNC does machining/turning in a new revolutionary way! Up to 14"

Diameter CNC, spindle RPMs Max 400 RPM, Face Head Diameter 2.75", X Axis Stroke 2.75", Z Axis Stroke 16". Threading, beveling, boring, grooving and many more.

T-Drill Industries Inc

Booth A4508
TEC-220

The TEC-220 is a powerful collaring machine for up to SCH 40 pipes. The TEC-220 forms mechanically extruded outlets up to Ø 8" directly on run pipes up to 32" main pipes.

TRUMPF North America

Booth A2904
TruLaser Tube 5000 Fiber



Packed with optimized features such as BevelCut, RapidCut, a maximum load weight of 18lbs per foot and a solid-state 4 kW laser, TRUMPF's new TruLaser Tube 5000 fiber can handle a wide range of materials, from mild, stainless steel to non-ferrous metals.

Tube & Pipe Producing

Kent Corporation

Booth D45946
Termomacchine High-Frequency Induction Welders



Termomacchine high-frequency induction welders power up to 800kW in the same chassis, while providing substantial power savings to your automatic tube mill production line.

Thermatool Corp

Booth D45738
HAZControl® Technology HF Welders



Thermatool HAZControl® Technology HF Welders enable tube and pipe producers to deliver welds with uniform and repeatable weld characteristics.

Waterjet

BARTON International

Booth A4574
B.A.R.T.® - BARTON Abrasive Removal Tool



BART is an easy-to-use, portable waterjet abrasive removal system that achieves rates of >3,000 lbs./hr. A convenient, efficient, cost-effective piece of equipment every waterjet operation needs. Made in the USA.

Flex Machine Tools

Booth A5160
FlexJet



Waterjet with the top speed, maximum acceleration, proven performance, and reliable service. FlexJet will cut virtually any shape in a single step with our dynamic 5-axis cutting head.



HIGH CAPACITY. COMPACT. PREMIUM FEATURES.

Koike's MD Series Power Elevating Head and Tailstock offers rugged design and premium features all in one compact package. With high-capacity, precision guidance throughout the elevation range, any size shop is ensured reliable results and long-lasting performance. Down to the smallest detail, the MD Series delivers on Koike's signature exacting standards.

Stop by Booth #B17016



SIMPLY BETTER BUILT

Welding Positioners | Turning Rolls | **Headstocks & Tailstocks** |

Welding Manipulators | Tank Fabrication | Weld Seamers | Welding Packages

Waterjet

Jet Edge

Booth A4562

Jet Edge High Velocity Pump with Advanced Controls



Jet Edge High Velocity Pumps feature advanced controls for optimum user interface and predictive maintenance capabilities.

Welding Consumables

Blue Demon Welding Products

Booth B20074

Blue Demon True Flex



True Flex Bendable Tungsten Electrodes by Blue Demon Bends at room temperature for tight spaces and difficult torch angles. Works great on both AC and DC applications. Easy start and restrikes with excellent arc stability.

Cerbaco Ltd

Booth B37038

CERBACO Flexback Conformable Weld Backing



Pliable weld backing for use in CJP open root welding. This technology provides full support for a weld puddle and produces a symmetrical back bead while conforming to any geometry.

Norton Abrasives

Booth B35054

BlazeX F980 with Cool Friction Technology



The BlazeX F980 fiber discs increase cut rate and life with technology called Cool Friction which dissipates heat as you grind, reducing rework and extending disc life.

Welding Machines/ Equipment

Amada America Inc

Booth A2104

FLW ENSIS Fiber Laser Welder



The FLW achieves high-quality welds not possible with a conventional laser welder. This solution utilizes auto beam focus, a patented rotating lens, and a Teaching Assist System that utilizes a camera to prevent deviation from the targeted welding path.

AXXAIR USA

Booth B15019

SATFX Orbital Welding Heads



Range of closed SATFX welding heads enables high quality welds in a minimal space and can easily be transformed into a cassette machine.

Beveler USA Inc

Booth B27049

X-PIPE Beveler



Machining of pipes from \varnothing 3.75" (95 mm). Unlimited max diameter, possible for flat materials.

Kalas

Booth B33034

SOOW Power Cord



Heavy duty flexible cord for indoor and outdoor use manufactured by Kalas with an over 60+ year history of quality and expertise.

Kjellberg Cutting, Inc

Booth A6121

Q-Series High Definition Plasma Cutting



The Q series is the latest in Kjellberg's line-up of high-definition plasma cutting systems and offers digital control through real-time communication with its components and a browser-based operator interface. Kjellberg's Q is ready for a digital world.

Primo Automation Systems

Booth B17074

ABW Series Pull-Through Welder



Primo Automation's ABW series provides advanced sub-arc Pull-Through welding technology for the fabrication of steel beams for the Pre-Engineered Buildings, Bridge and Steel Construction industries.

SanRex Corporation

Booth B34058

200PW (200amp Plasma Arc Welding - PAW System)

SanRex 200PW Plasma welding system offers: increased productivity, consistent arc starting etc. and is self-contained with a 200A power supply, coolant recirculator and control console.

Techniweld USA

Booth B34024

**Armour Guard Clairvoyant
2x4.25" Multi Shade Lens**



2 x 4.25" Multi Shade Auto-Darkening Filter Lens. It is crystal clear at shade 3, is ultra-thin, all-digital, and has ultra-fast 1/16000th sec switching speeds for flicker-free TIG welding >3A.

Weil Technology North America

Booth A3218

Flexible Laser Solutions with FLC CutFusion

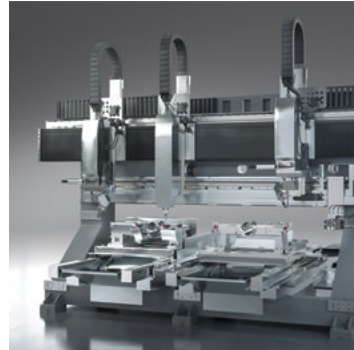

The FLC CutFusion by Weil Technology opens up potential for 3D processing with highest precision in simultaneous laser cutting and welding in one machine. Up to three processing optics can be mounted on one joint drive axis.



- ✓ Plasma Cutting & Marking
0.018 to 3 inches
- ✓ Made in Germany
- ✓ Industry 4.0

Visit us at Booth #A6121
FABTECH Chicago, IL
September 13-16, 2021



**VISIBLY DIFFERENT
PLASMA CUTTING 4.0**

www.kjellbergcutting.com



SPECIAL EVENTS

There are a lot of great events happening this year at FABTECH. You won't want to miss the keynotes, expert panel discussions, 3D/Additive Manufacturing Showcase, and much more.

All events are free and open to all attendees.

MONDAY, SEPTEMBER 13

KEYNOTE PRESENTATION | 8:30 AM - 9:30 AM

FABx TECH TALKS

This year's FABx will feature a powerful lineup of visionary leaders who are transforming the future of manufacturing. These manufacturers are increasingly integrating technologies like automation, artificial intelligence/AI, and data analytics into all aspects of how they operate, from the production floor to the supply chain. Hear how these leaders stay competitive in this ever-changing tech world.

FABx SPEAKERS:



David Ankin
CEO, ToyMakerz, Inc.



Anna V. O'Brien
Smart Manufacturing
Leader, Panasonic



Keith Otterstatter
Director of Operations,
Polaris Inc.

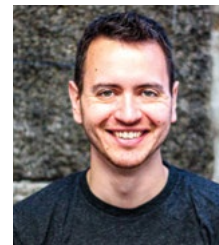

Scott Sawyer
Co-Founder & CTO
Paperless Parts, Inc.



Jon Sobel
Co-Founder,
CEO Sight Machine

LEADERSHIP EXCHANGE | 12:30 PM - 1:30 PM

EXPLORE THE FUTURE OF ADVANCED MANUFACTURING

Advanced manufacturing is transforming the landscape of how we operate daily. Listen to our panel of experts to hear how other organizations are using advanced manufacturing for technology adoption in both products and processes and how to use that technology to remain competitive.



MODERATOR:
Dave O'Neil
Vice President,
SME Media

PANELISTS:

Anna V. O'Brien, Smart Manufacturing Leader, Panasonic
Keith Otterstatter, Director of Operations, Polaris Industries Inc.
Scott Sawyer, Co-Founder & CTO, Paperless Parts, Inc.
Jon Sobel, Co-Founder, CEO, Sight Machine



TUESDAY, SEPTEMBER 14

KEYNOTE PRESENTATION | 8:30 AM - 9:30 AM

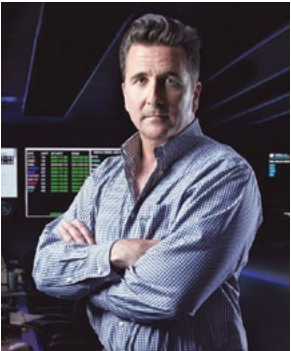

ADAM STELTZNER, Leader & Chief Engineer, NASA Mars 2020 Mission, Rover Perseverance

Into the Unknown: How Leadership, Ingenuity, and Perseverance Put a Rover on Mars

Only Adam Steltzner and his talented team at Jet Propulsion Lab could follow their “Curiosity” rover success with the stunning Mars 2020 mission to land the rover “Perseverance” on the red planet. The magnificent landing on Mars on February 18, 2021 was akin to hurling a dart from New York City to land in a 5-foot circle in Washington DC. The successful mission stands as an extraordinary leadership accomplishment in the midst of a global pandemic. In his exhilarating keynote, full of fascinating anecdotes and breathtaking images, Steltzner shares his own innovation challenges, leadership struggles, and flawless execution. Most importantly, he shows how you can overcome daunting obstacles in times of uncertainty and change.

LEADERSHIP EXCHANGE | 12:30 PM - 1:30 PM

STATE OF THE INDUSTRY: Navigating into 2022

The manufacturing industry is in a constant state of transformation. Manufacturers are faced with pressing questions as they strive to meet needs in supply, labor, and new technologies. What does future steel-making capacity look like in North America? What can shops do to maintain material inventories and minimize risk? How can manufacturers streamline quoting activities, eliminate redundancies and manual intervention when it comes to front office activities and shop floor production? How can automation help increase or save jobs? Our panel of experts will focus on addressing these questions and more as we look ahead to 2022.



MODERATOR:
Dan Davis
Editor-in-Chief,
The FABRICATOR®



Todd Ludlow
President, Ludlow
Manufacturing



Adria Haines
Regional Head of
Smart Factory
Solutions, Bystronic



Bryan Tice
Senior Partner, Metal
Edge Partners LLC



WEDNESDAY, SEPTEMBER 15

KEYNOTE PRESENTATION | 8:30 AM - 9:30 AM



DAVID ANKIN, CEO of ToyMakerz, Inc.

David Ankin is a hands-on entrepreneur, former stunt man, motorcycle racer, and custom motor vehicle fabricator that specializes in one-off custom builds & OEM enhancements for anything with wheels. As the owner of the shop Toymakerz, Ankin is living his dream creating everything from monster trucks to race cars on his TV show of the same name, ToyMakerz. The series follows his team as they bring unrivaled ingenuity and a unique skill set to motorized builds for a wide array of customers. On stage, Dave will share his secrets to success as a leader in the fabrication business and how his father has been his biggest inspiration.

LEADERSHIP EXCHANGE | 12:30 PM - 1:30 PM

WHY CAN'T THEY JUST WORK TOGETHER? Importance of Mobile Robot and Standard Robot Interoperability to Increase Adoption

As anyone who has ever designed, built, or deployed robots can tell you - no one robot can do it all. As demand grows for automation, companies are increasingly requiring robots for specialized tasks within logistics and manufacturing applications. It is therefore imperative that robots and mobile robots seamlessly work well together. Thankfully, there are several organizations within the robotics and automation communities working hard to create technology, standards, and best practices to address this.

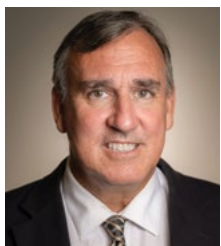

MODERATOR:
Arnie Kravitz
Chief Technology Officer, ARM Institute



Samir Patel,
Senior Director of Robotics Engineering-Kawasaki Robotics (USA), Inc.



Aaron Prather
Senior Advisor-Technology Research & Planning, FedEx



Jason Walker,
CEO & Co-Founder, Waypoint Robotics



Ben Waters, CEO & Co-Founder,
Wibotic





THURSDAY, SEPTEMBER 16

KEYNOTE PRESENTATION | 8:30 AM - 9:30 AM

ADAM GENEI, Owner of Mobsteel and Detroit Steel Wheel Co.

The Greatest Machines Ever Made: Cultivating the Next Generation of American Workers



Adam will discuss his workforce development formula, which has created a positive, invested, and competitive team, embodying the “out work everyone” attitude. His talk aims to prepare our next generation of workforce for navigating their way through our trades and businesses. Focusing on character, work ethic, and long-term thinking, Adam will share the milestones and learning moments he has experienced while building his worldwide brands Mobsteel and Detroit Steel Wheel Co.

LEADERSHIP EXCHANGE | 11:00 AM - 12:00 PM

ATTRACTING & PREPARING THE NEXT GENERATION OF MANUFACTURING TALENT

The skills gap could lead to a shortage of as many as 2.4 million manufacturing workers in the next decade. How do we get involved and share awareness to encourage the next generation to pursue manufacturing careers? This panel of experts will share how to engage, inspire, and prepare the next generation of manufacturing workforce.



MODERATOR:
Sheila LaMothe
Executive Director,
CCAI Finishing
Education Foundation



Ed Dernulc
Director -
Foundation, FMA



Nichol Lopriore
Executive Director,
PMA Education
Foundation



Rob Luce
Vice President, SME
Education Foundation



Monica Pfarr
Executive Director,
AWS Foundation

MONDAY, SEPTEMBER 13 - THURSDAY, SEPTEMBER 16

3D/ADDITIVE MANUFACTURING SHOWCASE

Located in South Hall, the showcase features industry-leading companies sharing 20-minute presentations on the latest in the Additive Manufacturing community.



MONDAY, SEPTEMBER 13

TECHNOLOGY	8:00 AM – 9:30 AM	10:30 AM – 12:00 PM	1:00 PM – 2:30 PM	3:30 PM – 5:00 PM
3D/ADDITIVE MANUFACTURING	■ F10: Fundamentals of AM (7 Processes, Hybrid, AM Enabled)	NEW! ■ F11: The Hidden Challenges: Is Additive Manufacturing for You?	NEW! ■ F12: Managing the AM Supply Chain	NEW! ■ F13: Ask the Panel of Additive Manufacturing Experts (BONUS SESSION)
AUTOMATION/ROBOTICS	NEW! ■ F20: Automation Adoption: What You Need to Know & Why	NEW! ■ F21: Five Steps to Creating Operational Excellence in Robotic Joining	■ WS3: Getting Started with Robotics: A Journey to the World of Robotics & Autonomous Systems Workshop (1:00 PM - 4:00 PM)	
CUTTING			NEW! ■ F32: The Most Versatile Machine Tool & 7 Habits of Highly-Effective Nesting Software	■ F33: Comparative Cutting
FINISHING			■ C12: I Want to Ecoat, Now What?	
			■ C22: Powder Coating Basics - A Fundamental Understanding of a Powder Coating System	
			NEW! ■ C32: An Architectural Update: Liquid and Powder Coatings	
	NEW! ■ C100: Industrial Finishing Safety Workshop - Day 1 (9:00 AM - 4:00 PM)			
FORMING & FABRICATING	■ F40: Press Brake for Engineers	■ F41: Tube Bending: Best Practices	■ F42: Coil Processing: Blanking, Leveling, and Deburring	■ F43: Roll Forming Basics
JOB SHOP	NEW! ■ WS7: Business Owners Guide to Protect, Value and Plan for the Future Workshop (8:00 AM - 12:15 PM)		NEW! ■ F72: Industrial Ventilation & Air Filtration: Understanding Options in System Design	■ F73: Estimating Software to Manage the Job Shop
LASER		NEW! ■ F31: How Much Laser Power Is Right for Your Business?		
LEAN	NEW! ■ F50: Lean Principle: Blue-Collar Kaizen: Leading Lean & Lean Teams	■ F51: Lean Principle: Getting Started with Your Lean Journey		NEW! ■ F53: Lean Tools: Production Floor Communication to Strengthen Employee Engagement & Standard Work
MANAGEMENT	■ F60: Breaking Boundaries for Operational Excellence	■ F61: Business Builders: Make Business Development a Competitive Advantage	NEW! ■ F62: Creating and Sustaining Cultures of Innovation in Manufacturing	■ F63: Strategies for Leading & Managing a Change Initiative
MARKETING & SALES	NEW! ■ WS8: Market and Build Your Fabrication Story Workshop (8:00 AM - 12:00 PM)		NEW! ■ F82: From Funnel to Flywheel: How to Maximize Your Marketing for Sales	NEW! ■ F83: Learn How to Optimize Your Sales Team's Funnel & Obtain Visibility into Your Sales Forecast
SMART MANUFACTURING	NEW! ■ F90: Meeting Changing Buyer Expectations Through Digital Transformation	NEW! ■ F91: IIoT to Improve Manufacturing Process	NEW! ■ F92: Digital Tools & Technology to Mitigate Project Risk	■ F93: Leveraging A.I. In Industrial Manufacturing
STAMPING	■ S10: What's Holding You Back? How to Optimize Your Press Line	■ S11: Understanding Servo Metal Stamping Presses, Proper Usage, Troubleshooting and Maintenance	NEW! ■ S12: Heat Treating Fundamentals, Vacuum Heat Treating and Applications	NEW! ■ S13: 5 Steps to Creating Operational Excellence in the Press Shop
WORKFORCE DEVELOPMENT	NEW! ■ F110: Winning the Workplace Challenge: Getting Along and Getting Things Done	NEW! ■ F111: Tutorial on How to Develop or Enhance Virtual Presentation & Internships	NEW! ■ F112: Three Key Areas that are Essential to Become a Better Leader	■ F113: Read (Hidden) Emotions - Know What Others are Thinking and Feeling
WELDING	■ W1: How to Create and Write a Quality Manual for the ATF Program			1:00 PM – 5:00 PM
	■ W2: Overview of Welding Inspection			1:00 PM – 5:00 PM

Detailed Conference Program session descriptions, speakers, pricing, room locations and more can be found at fabtechexpo.com/conference.

■ Basic ■ Intermediate ■ Advanced

TUESDAY, SEPTEMBER 14

TECHNOLOGY	8:00 AM - 9:30 AM	10:30 AM - 12:00 PM	1:00 PM - 2:30 PM	3:30 PM - 5:00 PM
3D/ADDITIVE MANUFACTURING	NEW! ■ WS1: Navigating Technology and Design Considerations in Additive Manufacturing Workshop (8:00 AM - 12:00 PM)			■ F17: Viable Power Quality & Legal Issues to Sustain Additive Processes
AUTOMATION/ROBOTICS	NEW! ■ F24: Position Your Business for Future Growth & Speed Up the Workforce with Automation Process	NEW! ■ F25: Do You Know How Much Money You Are Losing Due to Equipment Downtime?	NEW! ■ WS4: An Introduction to the World of AGVs: Identifying the Considerations for a Successful Application Workshop (1:00 PM - 5:00 PM)	
CUTTING		NEW! ■ F35: Advancements in Cutting Automation		
FINISHING	NEW! ■ C14: Automation - Controlling the Process	NEW! ■ C15: Busting the Myths: What Really Matters in Metal Cleaning	NEW! ■ C16: Improving System Performance	
	■ C24: I Want to Powder Coat, Now What?	■ C25: Optimizing Your Powder Coating Operations	NEW! ■ C26: Operating Liquid Systems Efficiently	
	■ C34: Pretreatment - Get The Latest and Greatest!	■ C35: See It, Touch It, Fix It - Identifying and Solving Finishing Defects	NEW! ■ C36: Solutions for Metal Cleaning Issues	
	NEW! ■ C100: Industrial Finishing Safety Workshop - Day 2 (8:00 AM - 12:00 PM)			
FORMING & FABRICATING	■ F44: Roll Forming: In-line Punching, Cutoff Dies, and Press Tonnage	■ F45: Machine Safeguarding	■ F46: Roll Forming: Justification and Welding Profiles	NEW! ■ F47: Addressing Modern Day Metals in the Roll Forming Process
JOB SHOP	NEW! ■ F74: Improving Production Outcomes Through Cross-Crew Synthesis	NEW! ■ F75: Made to Order Tooling & Production Scheduling	■ F76: Are Scheduling Problems Really Symptoms: "A Quick Fix for Job Shops"	NEW! ■ F77: Transforming a Tired Manufacturing Company Back to an Industry Leader
LASER	NEW! ■ F34: Laser Ecosystems for Fiber Laser Cutting & Surface Cleaning		NEW! ■ F36: Advantages of Laser Welding Applications	NEW! ■ F37: Industrial Laser and Cutting Applications & Solutions
LEAN	NEW! ■ WS6: Lean Overview - Principles & Practices Hands-On Learning Workshop (8:00 AM - 12:00 PM)		■ F56: Lean Principle: Value Stream Mapping: Understanding the Whole from Sales to Shop to Customer	■ F57: Lean Principle: A3 Thinking; Developing People & Solving Problems
MANAGEMENT	NEW! ■ F64: Gen Z Is Coming - What You Need to Know for Your Business	NEW! ■ F65: That Was Fun! Where Are We in 2021?	NEW! ■ F66: Connection Perfection: The Business Case for Building Community	NEW! ■ F67: Strategies To Create a Workplace Culture That Works!
MARKETING & SALES	NEW! ■ F84: Winning With Social Media & Website Connections	NEW! ■ F85: Ensuring A Successful Product Launch	NEW! ■ F86: Building an Inside (Outbound) Sales Team	NEW! ■ F87: Client Engagement: Compete on Awesome
SMART MANUFACTURING	NEW! ■ F94: Key Steps to Jump Start Your Smart Manufacturing Journey	NEW! ■ F95: The Manufacturers Data-Driven Playbook	NEW! ■ WS10: Digital Transformation Models for Industry 4.0 Workshop (1:00 PM - 4:00 PM)	
STAMPING	NEW! ■ S14: Planning and Estimating Stamping Dies	■ S15: Processing Parts for Progressive Dies - Evaluating Strip Layouts	■ S16: Processing Parts for Progressive Dies - Engineering Principles and Design Guidelines	■ S17: Automatic In-Die Part Quality Monitoring & Tool Adjustments
WORKFORCE DEVELOPMENT	NEW! ■ F114: Blue-Collar Leadership® & Culture: The 5 Components for Building High-Performance Teams	NEW! ■ F115: The Art of Assertive Communication	■ F116: How to Attract and Keep the Right Talent	NEW! ■ F117: Give Your Employees C.R.A.P...The Success Formula for Building Employee Loyalty

WELDING	W3: AWS/Weld-Ed Conference - Project Based Welding Curriculum	8:00 AM - 4:00 PM
	W4: Aluminum Welding	8:00 AM - 11:00 AM
	W5: Advanced NDT Methods and Your Future as a CWI	8:00 AM - 11:00 AM
	W6: Metallurgy (Intermediate)	1:00 PM - 5:00 PM

Detailed Conference Program session descriptions, speakers, pricing, room locations and more can be found at fabtechexpo.com/conference.

■ Basic ■ Intermediate ■ Advanced

WEDNESDAY, SEPTEMBER 15

TECHNOLOGY	8:00 AM – 9:30 AM	10:30 AM – 12:00 PM	1:00 PM – 2:30 PM	3:30 PM – 5:00 PM
3D/ADDITIVE MANUFACTURING	NEW! ■ WS2: Pre and Post Processing of Additive Parts Workshop (8:00 AM - 12:00 PM)		■ F101: Continuous Improvement for Additive Manufacturing Initiatives	NEW! ■ F102: Materials and Joining for Plastic & Metal AM Technology
AUTOMATION/ROBOTICS	NEW! ■ F28: Understanding & Automating Your Data to Stay Competitive	NEW! ■ F29: Automating Press Brake & Bending Systems	■ F201: What You Need to Understand Before Thinking About Running Your Shop Lights-Out	NEW! ■ F202: Automation for Metal & Finishing Processes
CUTTING	NEW! ■ F38: Advancements in 3D Plasma and Waterjet Cutting	■ F39: Getting the Most Out of Your Waterjet		
FINISHING	NEW! ■ C18: Robotic Finishing for General Industry	NEW! ■ C19: Finishing's Future Through Automation	NEW! ■ C101: Can I Justify a Batch Powder Coating System?	
	NEW! ■ C28: Finishing Systems - Design and Project Management	■ C29: Automating Your Powder Coating Line	NEW! ■ C201: Mastering Surface Preparation	
	NEW! ■ C38: Advancements in Powder Coating Materials	NEW! ■ C39: Technology Update - Heat Sensitive Substrates	■ C301: Preventative Maintenance and Troubleshooting Your Powder Coating Operations	
	NEW! ■ C200: Powder Coating 101 Workshop in Spanish - Básicos del Recubrimiento en Polvo 101 Taller en Español - Day 1 (9:00 AM - 4:00 PM)			
FORMING & FABRICATING	■ F48: Tube Bending and Hydroforming	■ F49: Roll Forming: Advanced Techniques and Design	■ F401: Coil Processing: Slitting Thin Materials, Leveling, & Deburring	■ F402: Advanced Solutions for Tube and Pipe
JOB SHOP	■ F78: Your Family Business: Everything You Need to Know	NEW! ■ F79: Revolutionizing the manufacturing Industry with XR Technology	■ F701: Innovative Manufacturers: To Patent or Not to Patent?	NEW! ■ F702: Building Business Resilience Next Steps Now
LASER			NEW! ■ WS5: Laser Fabrication: Welding, Cutting & Additive Workshop (1:00 PM - 5:00 PM)	
LEAN	■ F58: Lean Tools: Go to Gemba	NEW! ■ F59: Lean Tools: Hoshin Kanri	NEW! ■ F501: Lean Tools: Mastering Mixed Model Flow for a High-Performance Operation	NEW! ■ F502: Lean Principle: Long-Term & Four System View of Lean for Manufacturing Success
MANAGEMENT	NEW! ■ F68: How to Build a Better Supply Chain for your Business	NEW! ■ F69: Thriving Under Pressure: Revenue Growth In a New Business Paradigm	NEW! ■ F601: Markets & Energy Incentives for Manufacturing	■ F602: Brainstorming & Problem Solving Tools for Leaders
MARKETING & SALES	NEW! ■ F88: Creating an Inbound Marketing Action Plan for Manufacturers Who Are Prioritizing Online Lead Generation	NEW! ■ F89: How Industrial and Manufacturing Companies Create Predictable Revenue Growth	NEW! ■ WS9: Essential Sales Strategies for Manufacturers in 2021 and Beyond - Workshop (1:00 PM - 5:00 PM)	
SMART MANUFACTURING	NEW! ■ WS11: Smart Manufacturing Bootcamp (8:00 AM - 5:00 PM)			
STAMPING	■ S18: Deep Drawing Cylindrical Shells: Tooling Principles and Design Guidelines	■ S19: Deep Drawing Rectangular Box Shells: Tooling Principles and Design Guidelines	NEW! ■ S101: Reducing Cost and Risk to Timing Associated with Tool Buy-Off	■ S102: Evaluating Your Lubricants for Performance and Safety
WORKFORCE DEVELOPMENT	NEW! ■ WS12: Leadership Skills & Development Workshop (8:00 AM - 12:30 PM)		NEW! ■ F210: Diversity, Equity, and Inclusion; Future-Proofing Your Workforce	■ F211: Why You Can't Get Your People Motivated & What To Do About It
WELDING	■ W7: Additive/ASME			8:00 AM - 11:00 AM
	■ W8: Metallurgy (Advance)			1:00 PM - 5:00 PM

Detailed Conference Program session descriptions, speakers, pricing, room locations and more can be found at fabtechexpo.com/conference.

■ Basic ■ Intermediate ■ Advanced

THURSDAY, SEPTEMBER 16

TECHNOLOGY	8:00 AM - 9:30 AM	10:30 AM - 12:00 PM	1:00 PM - 2:30 PM	3:30 PM - 5:00 PM
AUTOMATION/ROBOTICS	NEW! ■ F203: Optimize Your Automation Joining Process			
FINISHING	NEW! ■ C200: Powder Coating 101 Workshop in Spanish - Básicos del Recubrimiento en Polvo 101 Taller en Español - Day 2 (8:00 AM - 12:00 PM)			
FORMING & FABRICATING	NEW! ■ F403: Form Tapping	NEW! ■ F404: Combination Hybrids - An Arranged Marriage by Manufacturers		
SMART MANUFACTURING	■ F903: The Promise of Industry 4.0 & Lean Management	NEW! ■ F904: Driving Change with Your Data & Implementing an Industry 4.0 Strategy		

WELDING SESSIONS	W9: Weld Cracking	8:00 AM - 11:00 AM
	W10: ASME Codes and Standards Update	8:00 AM - 11:00 AM



Detailed Conference Program session descriptions, speakers, pricing, room locations and more can be found at fabtechexpo.com/conference.

EXPERIENCE LEVELS

Use this key along with the Schedule-at-a-Glance to find the education level that meets your needs.

- **Basic** - Recommended for the attendee who is new to the industry or needs a refresher on the topic.
- **Intermediate** - Designed for the attendee who already has a basic understanding of the subject matter.
- **Advanced** - For the attendee with several years of experience who is seeking more in-depth information.

CONFERENCE TRACK SPONSORS:

AUTOMATION/ROBOTICS

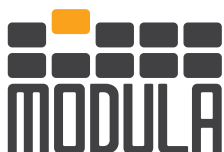

SMART MANUFACTURING



2021 SPECIAL PRICING INFORMATION

The FABTECH event partners want to give back to manufacturing and support training and education needs for 2021 and beyond. We want to help companies prioritize training right now by offering the **LOWEST RATES** ever on our conference programs. **With these special rates, there has never been a better time to take advantage of all the learning opportunities at FABTECH.**

EXHIBITS ONLY

Registration is FREE through September 9.

Beginning September 10, the cost to attend the exhibits is \$50. AWS, FMA, SME, PMA, and CCAI members may always attend the exhibits for FREE with proof of membership.

CONFERENCE TRACKS

- 3D/Additive Manufacturing
- Automation/Robotics
- Cutting
- Laser
- Finishing
- Forming & Fabricating
- Job Shop
- Lean
- Management
- Marketing & Sales
- Smart Manufacturing
- Stamping
- Workforce Development

FABTECH Items and Pricing	Member	Non-member
1 Session	\$150	\$170
2 Sessions	\$200	\$220
3 Sessions	\$255	\$285
4 Sessions	\$320	\$340
Full Conference: (5 or more sessions) BEST VALUE!	\$375	\$395
Half-Day Workshops	\$225	\$245
Full-Day Workshops	\$375	\$395
Two-Day Finishing Workshops	\$545	\$545

WELDING TRACK

	Member	Non-member*
AWS/Weld-Ed Conference	\$25	\$50
Half-Day Welding Sessions	\$345	\$430

* Non-member price for AWS Welding Sessions only includes a one-year AWS Individual Membership.

CONFERENCE CANCELLATION POLICY: Cancellations and refund requests (for paid conference registrations) must be made in writing to Attn: Betsy Bonnell: FABTECH Conference Cancellation, or sent to bbonnell@sme.org no later than September 3, 2021, to receive a full refund minus a \$50 administrative fee. Cancellations received after this date are non-refundable. Substitutions allowed.

A MASTERPIECE OF
ARTIFICIAL INTELLIGENCE

Visit us at
FABTECH
BOOTH
A2923

ADVANCED GX-F

S E R I E S

The World's First Fully Automated **Smart** Laser Cell



For more info, visit mcmachinery.com



WATCH THE VIDEO!

 **MITSUBISHI LASER**



NORTH AMERICA'S LARGEST METAL FORMING,
FABRICATING, WELDING AND FINISHING EVENT

Fabricators & Manufacturers
Association, International®
2135 Point Blvd., Elgin, IL 60123

SEPT 13-16

MCCORMICK PLACE
Chicago, IL

SAVE \$50

Register Today at
fabtechexpo.com

Use the **Promo Code** next to your
address when registering online.



 **FABTECH**

MONTERREY, MEXICO
MAY 3-5, 2022

 **FABTECH**

TORONTO, ONTARIO
JUNE 14-16, 2022

 **FABTECH**

ATLANTA, GEORGIA
NOVEMBER 8-10, 2022



**DON'T MISS
THESE FABTECH
EVENTS IN 2022!**